

CENTRAL PICK UP LOOP FOR STEEL WHEEL RISERS - SWR-CPL-SM

APPROX WEIGHT: 197.80 lbs.
DOES NOT INCLUDE WEIGHT OF POWER OR PACKAGING!!!
*** ANY ADDITIONS, DELETIONS, OR OMISSIONS MUST BE CORRECTED ON THIS DRAWING AS THIS DRAWING WILL BE CONSIDERED ALL INCLUSIVE ***
ALL GRAPHICS PROVIDED ARE FOR REFERENCE ONLY. IF CERTAIN DIMENSIONS ARE CRITICAL PLEASE VERIFY THOSE DIMENSIONS WITH YOUR SALESPERSON

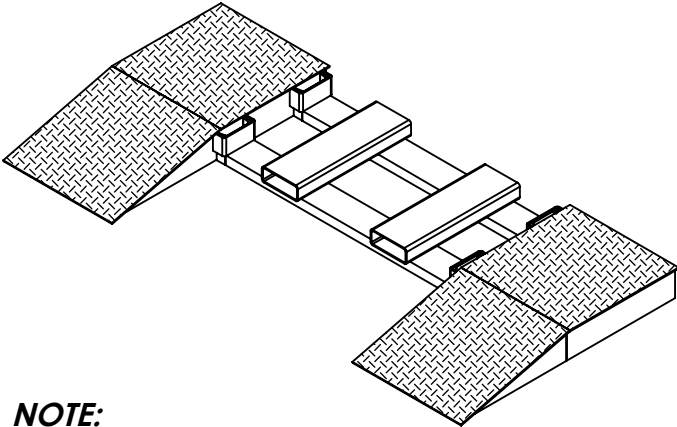
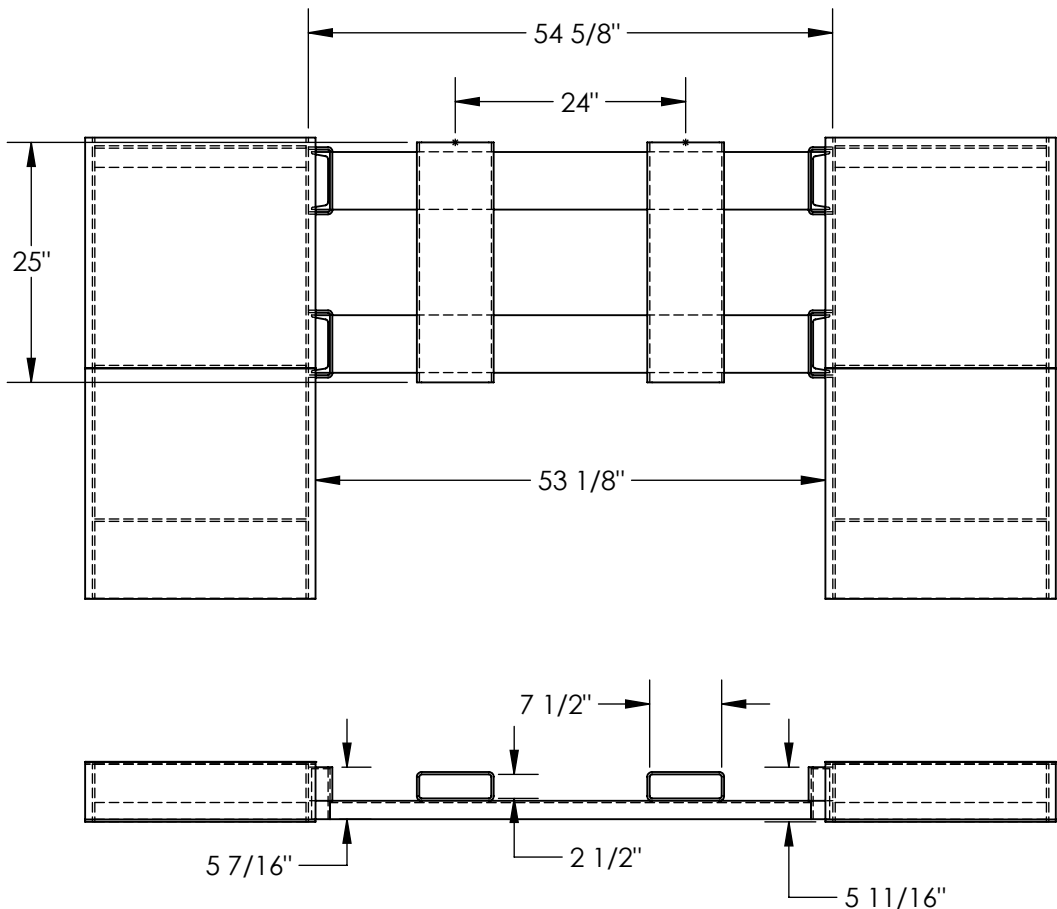

NOTE:

- *WHEEL RISERS SHOWN FOR REFERENCE ONLY, AND ARE AVAILABLE SEPARATELY**
- *SWR-CPL-SM OPTION REPLACES THE STANDARD FORK POCKETS ON THE WHEEL RISERS**
- *SWR-CPL-SM IS USED TO CONNECT TWO WHEEL RISERS (FACTORY INSTALLED).**
- *SWR-CPL-SM IS ONLY COMPATIBLE WITH SWR-18-6-48 & SWR-24-6-48**

STANDARD FEATURES

MODEL NUMBER IS SWR-CPL-SM
OVERALL WIDTH IS 54 5/8"
WIDTH BETWEEN RISERS WHEN INSTALLED IS 53 1/8"
OVERALL HEIGHT IS 5 7/16"
HEIGHT FROM GROUND TO TOP OF SIDE LOOPS WHEN INSTALLED IS 5 11/16"
OVERALL DEPTH IS 25"
7 1/2"W x 2 1/2"H FORK POCKETS ON 24" CENTERS
FORK ATTACHMENT INSERTS INTO LOOPS WELDED TO INNER SIDES OF WHEEL RISERS (SOLD SEPARATELY)
STEEL CONSTRUCTION, BROWN LIQUID PAINT FINISH

SPECIAL FEATURES

NONE

DIMENSION TOLERANCE ± 1/4"

APPROVAL	I, THE UNDERSIGNED, AGREE THAT THE PRODUCT AS REPRESENTED SATISFIES DESIGN AND DIMENSION REQUIREMENTS. I ALSO ACKNOWLEDGE MY DUTY TO CONFIRM PRODUCT AND INSTALLATION COMPLIANCE WITH ALL APPLICABLE FEDERAL, STATE AND LOCAL REGULATIONS AND STANDARDS.	
	ANY MODIFIED UNITS ARE NON-RETURNABLE	
	[] As drawn [] As marked	
	Signed: _____ Date: _____	

Printed Name: _____

LEAD TIME WILL START UPON RECEIPT OF SIGNED APPROVAL DRAWING

FOR INTERNAL USE ONLY PROJECT SIGN OFF	
SALES	
ENG.	
FAB.	
POWER	

DISTRIBUTOR'S NAME:		P.O.#
VESTIL MANUFACTURING		X
DRAWN BY: TJM		W.O.#
DATE: 01/19/18		X
REFERENCE: X	SCALE: 1:20	SALES: X
QUOTED LEAD TIME: X	QUOTE # X	FILE NAME:
		18-007-322