

WHEEL AND HANDLE KIT (BTA #13 & #14) - WHHDL-BTA-1314

APPROX WEIGHT: 10.67 lbs.
DOES NOT INCLUDE WEIGHT OF POWER OR PACKAGING!!!

ANY ADDITIONS, DELETIONS, OR OMISSIONS MUST BE CORRECTED ON THIS DRAWING AS THIS DRAWING WILL BE CONSIDERED ALL INCLUSIVE

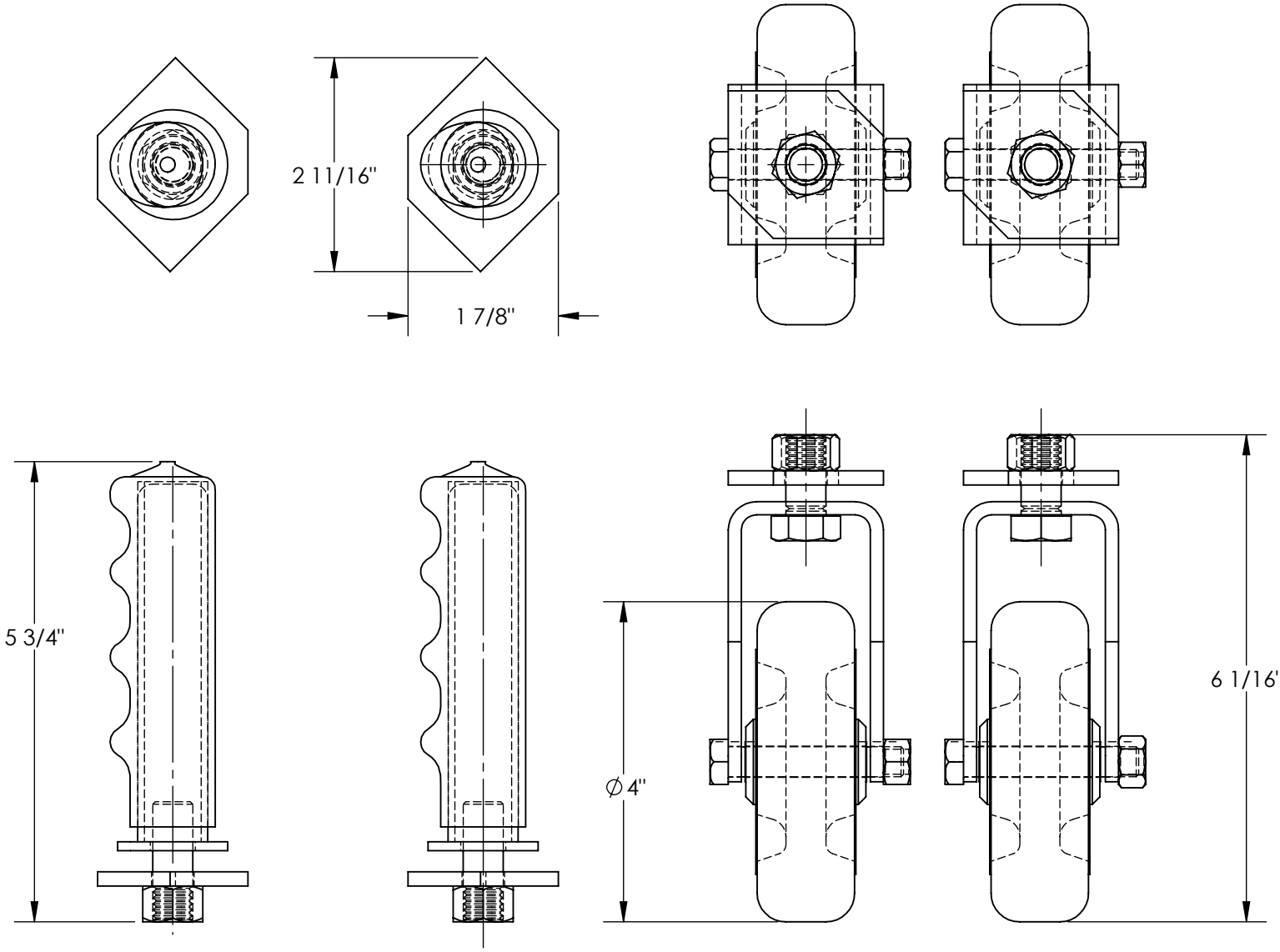

ALL GRAPHICS PROVIDED ARE FOR REFERENCE ONLY. IF CERTAIN DIMENSIONS ARE CRITICAL PLEASE VERIFY THOSE DIMENSIONS WITH YOUR SALESPERSON

STANDARD FEATURES

MODEL NUMBER IS WHHDL-BTA-1314

DIMENSION TOLERANCE ± 1/4"

USED ON THESE DOCKBOARD MODELS:
BTA-05006072 BTA-06006078 BTA-08006054
BTA-05006078 BTA-06006084 BTA-08006060
BTA-05006084 BTA-06006648 BTA-08006066
BTA-05006660 BTA-06006660 BTA-08006072
BTA-05007260 BTA-06007248 BTA-08006078
BTA-05007848 BTA-06007260 BTA-08006648
BTA-05007860 BTA-06007848 BTA-08006660
BTA-05008448 BTA-06007860 BTA-08007248
BTA-05008460 BTA-06008448 BTA-08007260
BTA-06006048 BTA-06008460 BTA-08007848
BTA-06006054 BTA-08005448 BTA-08007860
BTA-06006060 BTA-08005460 BTA-08008448
BTA-06006066 BTA-08006042 BTA-08008460
BTA-06006072 BTA-08006048
AND ALL BTA MODELS OF 10,000 LB. CAP. OR HIGHER.

OVERALL WIDTH IS 2 1/2"
OVERALL HEIGHT IS 6 1/16"

SPECIAL FEATURES
NONE

APPROVAL	I, THE UNDERSIGNED, AGREE THAT THE PRODUCT AS REPRESENTED SATISFIES DESIGN AND DIMENSION REQUIREMENTS. I ALSO ACKNOWLEDGE MY DUTY TO CONFIRM PRODUCT AND INSTALLATION COMPLIANCE WITH ALL APPLICABLE FEDERAL, STATE AND LOCAL REGULATIONS AND STANDARDS.	
	UNITS REQUIRING APPROVAL DRAWINGS OR MODIFIED ARE NON-RETURNABLE	
	[] As drawn [] As marked	
	Signed: _____ Date: _____	
	Printed Name: _____	
	LEAD TIME WILL START UPON RECEIPT OF SIGNED APPROVAL DRAWING	

DISTRIBUTOR'S NAME:		P.O.#
VESTIL MANUFACTURING		X
DRAWN BY: M.WILSON		W.O.#
DATE: 11/15/12		X
REFERENCE: X	SCALE: 1:2	SALES: X
QUOTED LEAD TIME: X	QUOTE # X	FILE NAME:
		11-007-122