



Vestil Manufacturing Corp.

2999 North Wayne Street, P.O. Box 507, Angola, IN 46703

Telephone: (260) 665-7586 -or- Toll Free (800) 348-0868

Fax: (260) 665-1339

Web: www.vestilmfg.com e-mail: info@vestil.com

H-GAL Series Galvanized Hoppers

Instruction Manual



*Hopper design is subject to change without notice. Your unit might be slightly different from the hopper shown.

Receiving instructions:

After delivery, IMMEDIATELY remove the packaging from the product in a manner that preserves the packaging; then inspect the product closely to determine whether it sustained damage during transport. **If damage is discovered during the inspection, immediately record a complete description of the damage on the bill of lading.** If the product is undamaged, discard the packaging.

NOTE:

Responsibility for complying with laws, regulations, codes, and non-voluntary standards enforced in the location where the product is used lies exclusively with the end-user.

Table of Contents

Specifications and Options.....	2 – 3
Signal Words.....	4
Hazards of Improper Use.....	4
Loading Instructions.....	9
Use Instructions.....	9
Stacking hoppers.....	10
Inspections & Maintenance.....	10
Limited Warranty.....	12

Table of Figures

H-25-LD/MD/HD-GAL hoppers exploded view & bill of materials.....	5
H-50-LD/MD/HD-GAL hoppers exploded view & bill of materials.....	6
H-100-LD/MD/HD-GAL hoppers exploded view & bill of materials.....	7
H-150-LD/MD/HD-GAL hoppers exploded view & bill of materials.....	8
Labeling Diagram.....	11

Specifications and Options

Dimensions, volume, uniform capacity, and lost load figures appear in the following diagrams and tables.

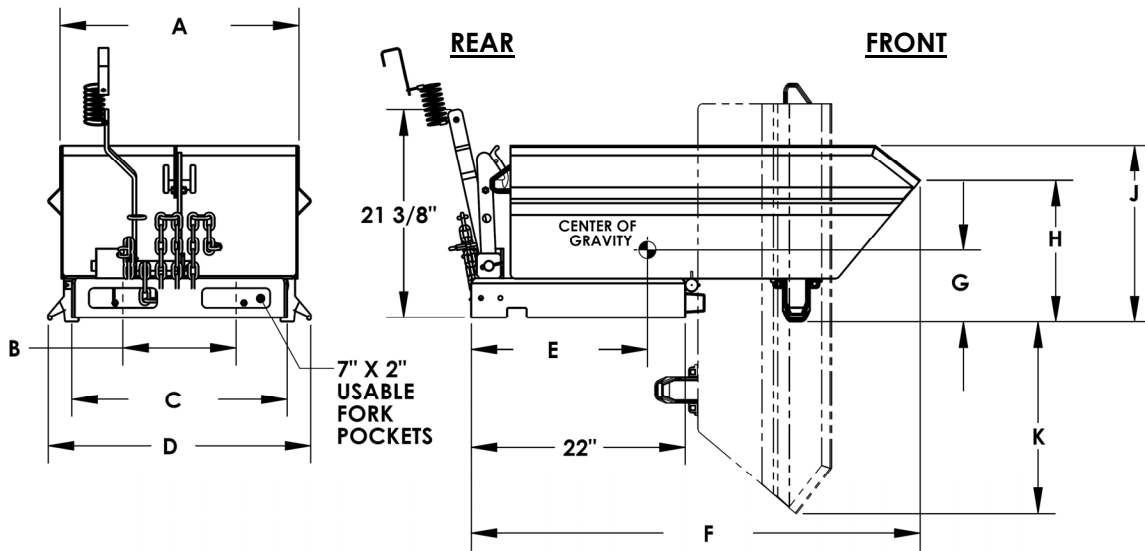

Model	A	B Distance between fork tube centers	C	D Overall width	E Horizontal center of gravity	F Overall depth	G Vertical center of gravity	H	J	K	Net weight/ Lost load	Uniform capacity	Volume
Light duty (12 gauge steel)													
H-25-LD-GAL	24 ⁹ / ₁₆ " 62.4cm	11 ⁵ / ₈ " 29.5cm	22 ¹ / ₈ " 56.2cm	27" 68.6cm	18 ³ / ₁₆ " 46.2cm	46 ¹ / ₈ " 117.2cm	7 ⁵ / ₁₆ " 18.6cm	14 ⁹ / ₁₆ " 37.0cm	18 ¹ / ₈ " 46.0cm	19 ¹¹ / ₁₆ " 50.0cm	206 lb. 93.5 kg	2,000 lb. 909.1 kg	¼ yd ³ 0.19 m ³
H-50-LD-GAL	24 ⁹ / ₁₆ " 62.4cm	11 ⁵ / ₈ " 29.5cm	22 ¹ / ₈ " 56.2cm	27" 68.6cm	19 ¹⁵ / ₁₆ " 50.6cm	51 ³ / ₁₆ " 130.0cm	11 ¹¹ / ₁₆ " 29.7cm	20 ⁹ / ₁₆ " 52.2cm	28 ³ / ₁₆ " 71.6cm	24 ³ / ₄ " 62.9cm	278 lb. 127 kg	2,000 lb. 909.1 kg	½ yd ³ 0.38 m ³
H-100-LD-GAL	48 ⁹ / ₁₆ " 123.3cm	21 ⁵ / ₈ " 54.9cm	32 ¹ / ₈ " 81.6cm	51" 129.5cm	20 ¹ / ₈ " 51.1cm	51 ³ / ₁₆ " 130.0cm	10 ¹³ / ₁₆ " 27.5cm	20 ⁹ / ₁₆ " 52.2cm	28 ¹ / ₈ " 71.4cm	24 ³ / ₄ " 62.9cm	405 lb. 185 kg	2,000 lb. 909.1 kg	1 yd ³ 0.76 m ³
H-150-LD-GAL	48 ⁹ / ₁₆ " 123.3cm	21 ⁵ / ₈ " 54.9cm	32 ¹ / ₈ " 81.6cm	51" 129.5cm	21 ¹ / ₂ " 54.6cm	56 ⁹ / ₁₆ " 143.7cm	14 ¹³ / ₁₆ " 37.6cm	26 ¹⁵ / ₁₆ " 68.4cm	38 ⁵ / ₈ " 98.1cm	30" 76.2cm	482 lb. 219 kg	2,000 lb. 909.1 kg	1½ yd ³ 1.15 m ³
Medium duty (10 gauge steel)													
H-25-MD-GAL	24 ⁹ / ₁₆ " 62.4cm	11 ⁵ / ₈ " 29.5cm	22 ¹ / ₈ " 56.2cm	27" 68.6cm	18 ³ / ₁₆ " 46.2cm	46 ¹ / ₈ " 117.2cm	7 ⁵ / ₁₆ " 18.6cm	14 ⁹ / ₁₆ " 37.0cm	18 ¹ / ₈ " 46.0cm	19 ¹¹ / ₁₆ " 50.0cm	206 lb. 93.5 kg	4,000 lb. 1,818 kg	¼ yd ³ 0.19 m ³
H-50-MD-GAL	24 ⁹ / ₁₆ " 62.4cm	11 ⁵ / ₈ " 29.5cm	22 ¹ / ₈ " 56.2cm	27" 68.6cm	19 ¹⁵ / ₁₆ " 50.6cm	51 ³ / ₁₆ " 130.0cm	11 ¹¹ / ₁₆ " 29.7cm	20 ⁹ / ₁₆ " 52.2cm	28 ³ / ₁₆ " 71.6cm	24 ³ / ₄ " 62.9cm	278 lb. 127 kg	4,000 lb. 1,818 kg	½ yd ³ 0.38 m ³
H-100-MD-GAL	48 ⁹ / ₁₆ " 123.3cm	21 ⁵ / ₈ " 54.9cm	32 ¹ / ₈ " 81.6cm	51" 129.5cm	20 ¹ / ₈ " 51.1cm	51 ³ / ₁₆ " 130.0cm	10 ¹³ / ₁₆ " 27.5cm	20 ⁹ / ₁₆ " 52.2cm	28 ¹ / ₈ " 71.4cm	24 ³ / ₄ " 62.9cm	405 lb. 185 kg	4,000 lb. 1,818 kg	1 yd ³ 0.76 m ³
H-150-MD-GAL	48 ⁹ / ₁₆ " 123.3cm	21 ⁵ / ₈ " 54.9cm	32 ¹ / ₈ " 81.6cm	51" 129.5cm	21 ¹ / ₂ " 54.6cm	56 ⁹ / ₁₆ " 143.7cm	14 ¹³ / ₁₆ " 37.6cm	26 ¹⁵ / ₁₆ " 68.4cm	38 ⁵ / ₈ " 98.1cm	30" 76.2cm	482 lb. 219 kg	4,000 lb. 1,818 kg	1½ yd ³ 1.15 m ³
Heavy duty (8 gauge steel)													
H-25-HD-GAL	24 ¹¹ / ₁₆ " 62.7cm	11 ⁵ / ₈ " 29.5cm	22 ¹ / ₈ " 56.2cm	27" 68.6cm	18 ⁵ / ₈ " 47.3cm	46 ³ / ₁₆ " 117.3cm	7 ¹ / ₂ " 19.1cm	14 ⁹ / ₁₆ " 37.0cm	18 ³ / ₁₆ " 46.2cm	19 ³ / ₄ " 50.2cm	228 lb. 104 kg	6,000 lb. 2,727 kg	¼ yd ³ 0.19 m ³
H-50-HD-GAL	24 ¹¹ / ₁₆ " 62.7cm	11 ⁵ / ₈ " 29.5cm	22 ¹ / ₈ " 56.2cm	27" 68.6cm	20 ³ / ₈ " 51.8cm	51 ¹ / ₄ " 130.2cm	11 ⁷ / ₈ " 30.2cm	20 ⁵ / ₈ " 52.4cm	28 ³ / ₁₆ " 71.6cm	24 ¹³ / ₁₆ " 63.0cm	312 lb. 142 kg	6,000 lb. 2,727 kg	½ yd ³ 0.38 m ³
H-100-HD-GAL	48 ¹¹ / ₁₆ " 123.7cm	21 ⁵ / ₈ " 54.9cm	32 ¹ / ₈ " 81.6cm	51" 129.5cm	21 ¹ / ₂ " 54.6cm	51 ¹ / ₄ " 130.2cm	11 ¹ / ₁₆ " 28.1cm	20 ⁵ / ₈ " 52.4cm	28 ³ / ₁₆ " 71.6cm	24 ¹ / ₂ " 62.2cm	455 lb. 207 kg	6,000 lb. 2,727 kg	1 yd ³ 0.76 m ³
H-150-HD-GAL	48 ¹¹ / ₁₆ " 123.7cm	21 ⁵ / ₈ " 54.9cm	32 ¹ / ₈ " 81.6cm	51" 129.5cm	21 ¹ / ₈ " 55.6cm	56 ⁹ / ₁₆ " 143.7cm	15 ³ / ₁₆ " 38.6cm	26 ¹⁵ / ₁₆ " 68.4cm	38 ¹¹ / ₁₆ " 98.3cm	30 ¹ / ₈ " 76.5cm	548 lb. 249 kg	6,000 lb. 2,727 kg	1½ yd ³ 1.15 m ³
Options													
H-DAMP-4	Hopper dumping speed regulator for medium duty (-MD) models										Net wt. = 30 lb. (13.6 kg)		
H-DAMP-6	Hopper dumping speed regulator for heavy duty (-HD) models										Net wt. = 40 lb. (18.2 kg)		
LEKP	"Leak-proof" welded hopper										Net wt. = 5 lb. (2.3 kg)		
H-DPLG-1	1" threaded drain plug located in bottom, left, rear corner; includes leak proof welds										Net wt. = 2 lb. (0.9 kg)		
H-DPLG-2	2" threaded drain plug located in bottom, left, rear corner; includes leak proof welds										Net wt. = 2 lb. (0.9 kg)		
LUG	4 welded lifting lugs (around perimeter of hopper mouth)										Net wt. = 23 lb. (10.5 kg)		

Heavy-duty polyethylene lids

Lid Model	Parts	Description	Fits Hopper Models	Net Weight
PLID-H-25	37-024-008-004 37-112-036 37-016-032	Plastic lid Long prop rod / hinge pin Bracket, lid hinge	H-25-LD, H-25-MD, H-25-HD	11 lb. 5.0 kg
PLID-H-50	37-024-008-003 37-112-036 37-016-032	Plastic lid Long prop rod / hinge pin Bracket, lid hinge	H-50-LD, H-50-MD, H-50-HD	13 lb. 5.9 kg
PLID-H-100	37-024-088-002 37-112-037 37-016-032	Plastic lid Long prop rod / hinge pin Bracket, lid hinge	H-100-LD, H-100-MD, H-100-HD	25 lb. 11.4 kg
PLID-H-150	37-024-088-001 37-112-037 37-016-032	Plastic lid Long prop rod / hinge pin Bracket, lid hinge	H-150-LD, H-150-MD, H-150-HD	27 lb. 12.3 kg

Caster kits

Model	Dimensions	Uniform Capacity	Caster Material	Quantity per Order	Net Weight
HOP-SC6-2	6" x 2" (15¼ x 5.1)cm	4,800 lb. 2,182 kg	Semi-steel	4	33 lb. 15 kg
HOP-SC8-2	8" x 2" (20.3 x 5.1)cm	4,800 lb. 2,182 kg	Semi-steel	4	42 lb. 19.1 kg
HOP-RC6-2	6" x 2" (15¼ x 5.1)cm	2,400 lb. 1,091 kg	Mold-on rubber	4	28 lb. 12.7 kg
HOP-RC8-2	8" x 2" (20.3 x 5.1)cm	2,400 lb. 1,091 kg	Mold-on rubber	4	37 lb. 16.8 kg
HOP-PC6-2	6" x 2" (15¼ x 5.1)cm	4,800 lb. 2,182 kg	Polyurethane on steel	4	33 lb. 15 kg
HOP-PC8-2	8" x 2" (20.3 x 5.1)cm	4,800 lb. 2,182 kg	Polyurethane on steel	4	42 lb. 19.1 kg
HOP-PHC6-2	6" x 2" (15¼ x 5.1)cm	4,800 lb. 2,182 kg	Glass-filled nylon	4	37 lb. 16.8 kg
HOP-PHC8-2	8" x 2" (20.3 x 5.1)cm	4,800 lb. 2,182 kg	Glass-filled nylon	4	54 lb. 24.5 kg
HOP-SC6-2.5	6" x 2½" (15¼ x 6.4)cm	6,000 lb. 2,727 kg	Steel	4	65 lb. 29.5 kg

NOTES:

1. "Uniform capacity" is the maximum weight that each caster set can support. It equals the combined weight of the hopper and its contents. **ONLY select a caster kit that equals or exceeds the uniform capacity of your hopper!**
2. H-25 and H-50 series hoppers receive 3 casters, rather than 4, as well as bolt-on stabilizing feet.

Signal Words

This manual identifies situations that could result in personal injuries or property damage with SIGNAL WORDS. These signal words draw attention to an associated safety message and indicate the seriousness of the described hazard.



Identifies a hazardous situation which, if not avoided, WILL result in DEATH or SERIOUS INJURY. Use of this signal word is limited to the most extreme situations.



Identifies a hazardous situation which, if not avoided, COULD result in DEATH or SERIOUS INJURY.



Indicates a hazardous situation which, if not avoided, COULD result in MINOR or MODERATE injury.



Identifies practices likely to result in product/property damage, such as operation that might damage the hopper.

Hazards of Improper Use

Study the entire manual before using the product for the first time. Read the manual when necessary to refresh your understanding of its content. If questions remain after you finish reading this manual, ask your supervisor or employer for assistance.



Material handling is dangerous. Improper or careless operation might result in serious personal injuries.

- *Failure to read & understand the instructions included in this manual before using or servicing the hopper is a misuse.*
- DO NOT use a malfunctioning or damaged hopper. Examples of damage include: 1) damage to the release lock lever assembly (see “Exploded parts” diagrams); 2) damaged or severely worn fork pockets; and 3) broken welds. Inspect the hopper before each use according to the inspection instructions on p. 10. DO NOT use the hopper unless it passes *every* part of the inspection.
- DO NOT lift the hopper until it is securely connected to the carriage of the fork truck with the safety chain. DO NOT use the hopper if the safety chain is damaged or missing;
- ONLY use this hopper with a powered forklift truck. DO NOT mount the hopper on stackers or manually propelled lift trucks.
- DO NOT fill the hopper with a load weighing more than its maximum rated load (see Tables, p. 2-3).
- NO ONE should travel under the hopper at any time while it is raised (or suspended from a hoist).
- NEVER wrap the release cable around your hand, fingers, or any other part of your body!
- **Hoppers with lifting lugs** can be lifted with overhead hoists and cranes. DO NOT lift a hopper unless the chute is securely latched to the frame.
- DO NOT allow people to ride on or in the hopper.
- DO NOT use the hopper if any label (see “Labeling Diagram” on p. 11) is unreadable or missing. Apply replacement labels before returning the hopper to service.
- ALWAYS apply proper lift truck operation techniques learned during your training program. Before raising the hopper from the floor, tilt the (forklift) mast toward the cab of the truck to ensure that the hopper will not slide off of the forks.
- DO NOT modify the hopper in any way without first obtaining express, written authorization! Unauthorized modifications might make the hopper unsafe to use and automatically void the Limited Warranty.
- DO NOT dump the hopper UNLESS every person in the vicinity moves to a safe location away from the dumping site.
- DO NOT dump the hopper if the forklift is on sloped terrain. Only dump the hopper while on level surfaces.
- Do not exceed the capacity of your hopper or fill it above the sides. Personal injury or permanent damage to the equipment could result from overloading.

H-25-LD/MD/HD-GAL hoppers exploded view and bill of materials

NOTE: SPRING 37-146-005 MUST BE WOUND AND HELD AT ONE COMPLETE REVOLUTION (360°) AND THEN INSTALLED.

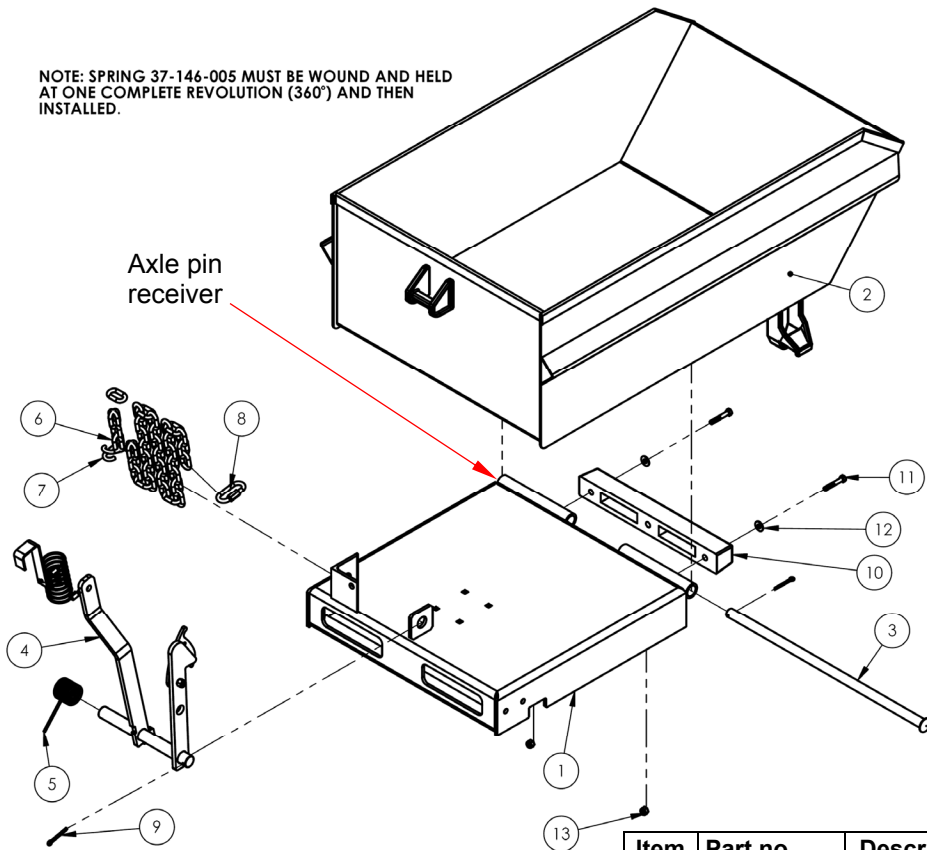

Item	Part no.	Description	Qty.
1	37-514-082	Weldment, frame, base	1
2	37-545-128 37-545-132	Weldment, chute, galvanized H-25-LD-GAL & H-25-MD-GAL H-25-HD-GAL	1 1
3	37-112-046	Pin, connecting rod	1
4	37-537-021	Weldment, lock, release lever assembly	1
5	37-146-005	Spring, torsion, hopper, release	1
6	09-145-018	Chain, $\frac{5}{16}$ " x 56" long	1
7	99-145-084	Lap link	1
8	99-145-053	$\frac{5}{16}$ " quick link	1
9	65127	Cotter pin, z-plated, $\frac{3}{16}$ " x 2"	2
10	29-048-061	Bumper, rubber	1
11	11061	Bolt, HHCS #2 z-plated, $\frac{5}{16}$ "-18 x 2"	2
12	33006	Flat washer, z-plated, USS, $\frac{5}{16}$ "	2
13	37021	Lock nut, gr 2, zinc finish, $\frac{5}{16}$ "-18	2

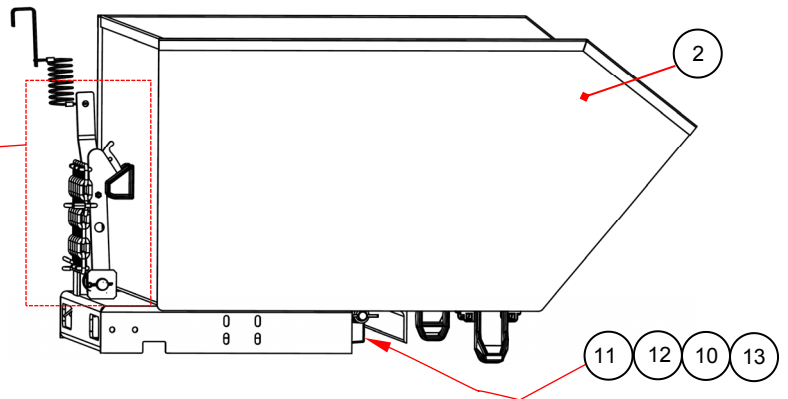
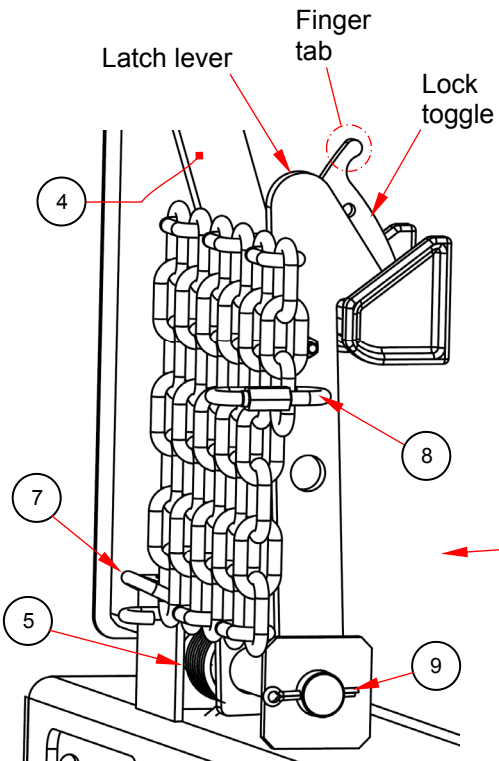

H-50-LD/MD/HD-GAL hoppers exploded view and bill of materials

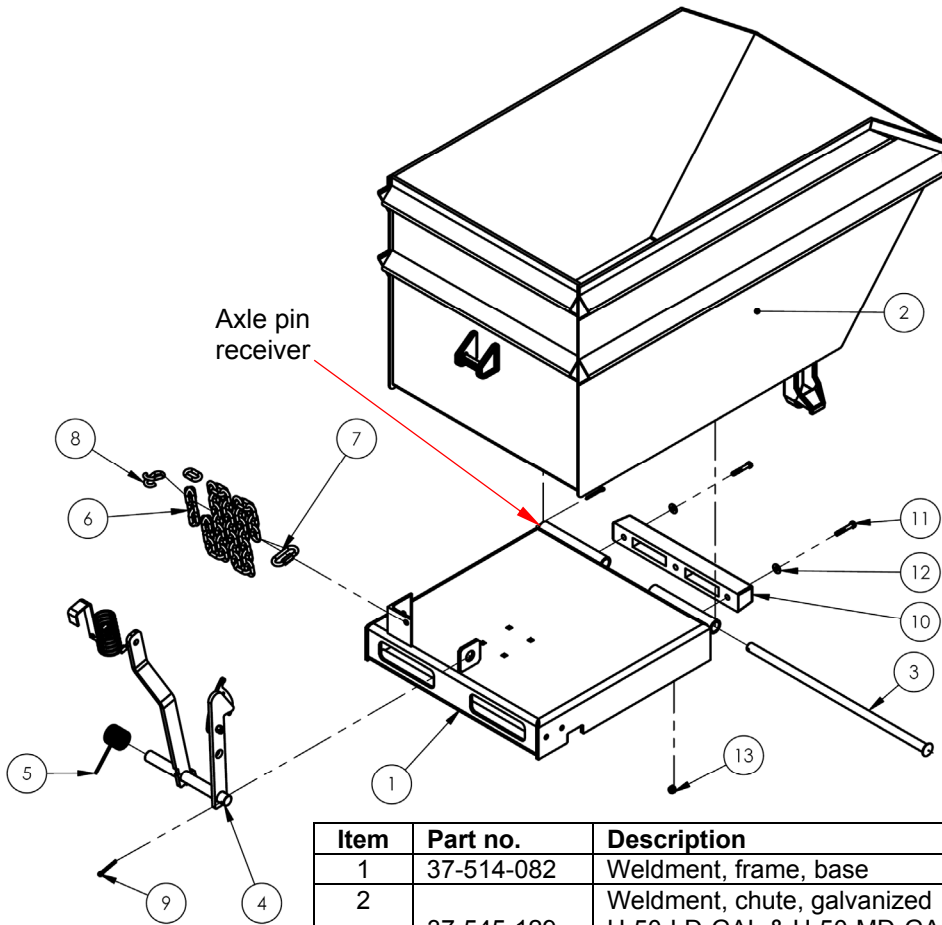

Item	Part no.	Description	Quantity
1	37-514-082	Weldment, frame, base	1
2	37-545-129	Weldment, chute, galvanized	1
	37-545-133	H-50-LD-GAL & H-50-MD-GAL	1
		H-50-HD-GAL	1
3	37-112-046	Pin, connecting rod	1
4	37-537-021	Weldment, lock, release lever assembly	1
5	37-146-005	Spring, torsion, hopper, release	1
6	09-145-018	Chain, 5/16" x 56" long	1
7	99-145-053	5/16" quick link	1
8	99-145-084	Lap link	1
9	65127	Cotter pin, z-plated, 3/16" x 2"	2
10	29-048-061	Bumper, rubber	1
11	11061	Bolt, HHCS #2 z-plated, 5/16"-18 x 2"	2
12	33006	Flat washer, z-plated, USS, 5/16"	2
13	37021	Lock nut, gr 2, zinc finish, 5/16"-18	2

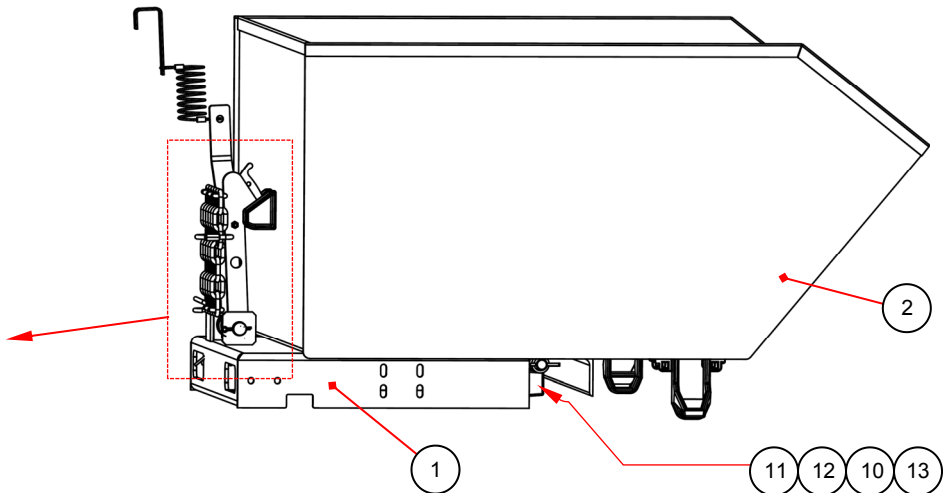
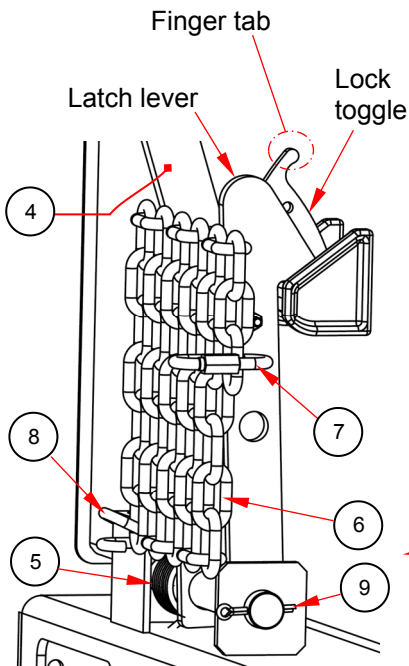

H-100-LD/MD/HD -GAL hoppers exploded view and bill of materials:

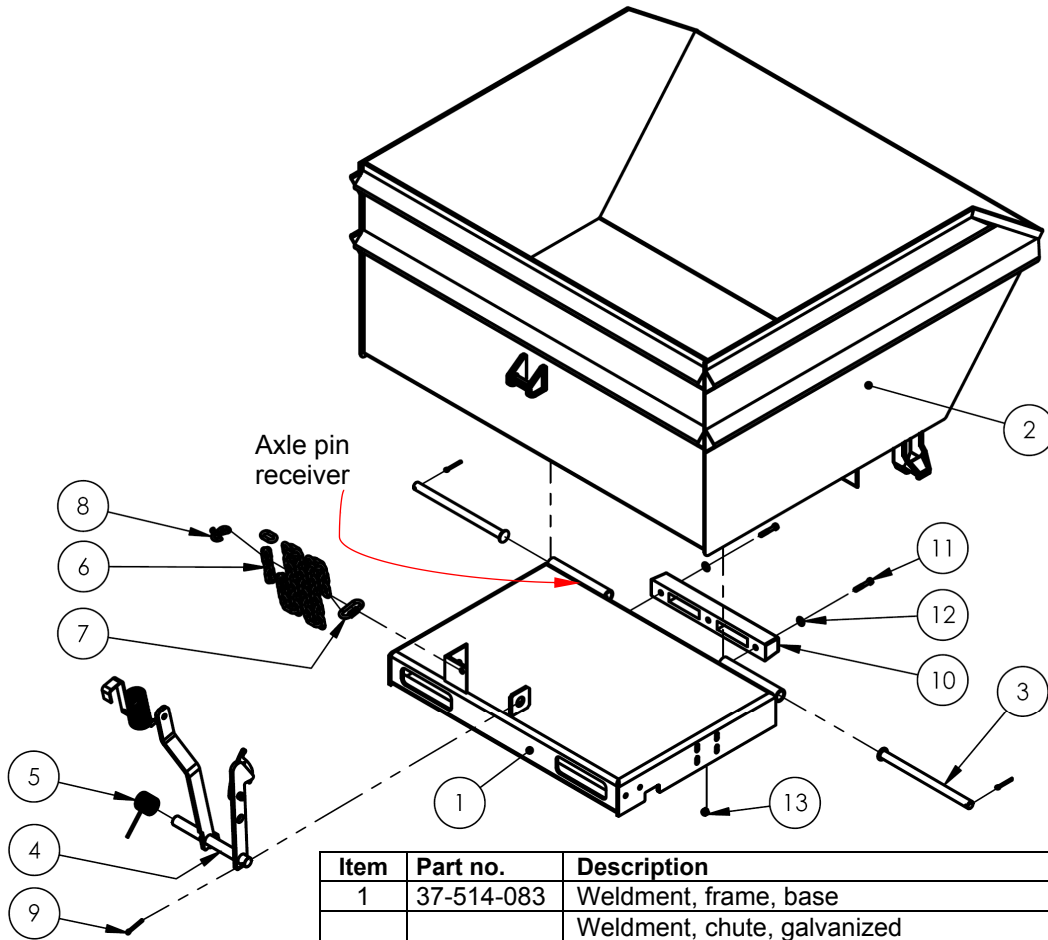

Item	Part no.	Description	Quantity
1	37-514-083	Weldment, frame, base	1
2	37-545-130	Weldment, chute, galvanized	1
	37-545-134	H-100-LD-GAL & H-100-MD-GAL	1
		H-100-HD-GAL	1
3	37-112-045	Pin, connecting rod	2
4	37-537-021	Weldment, lock, release lever assembly	1
5	37-146-005	Spring, torsion, hopper, release	1
6	09-145-018	Chain, $\frac{5}{16}$ " x 56" long	1
7	99-145-053	$\frac{5}{16}$ " quick link	1
8	99-145-084	Lap link	1
9	65127	Cotter pin, z-plated, $\frac{3}{16}$ " x 2"	3
10	29-048-061	Bumper, rubber	1
11	11061	Bolt, HHCS #2 z-plated, $\frac{5}{16}$ "-18 x 2"	2
12	33006	Flat washer, z-plated, USS, $\frac{5}{16}$ "	2
13	37021	Lock nut, gr 2, zinc finish, $\frac{5}{16}$ "-18	2

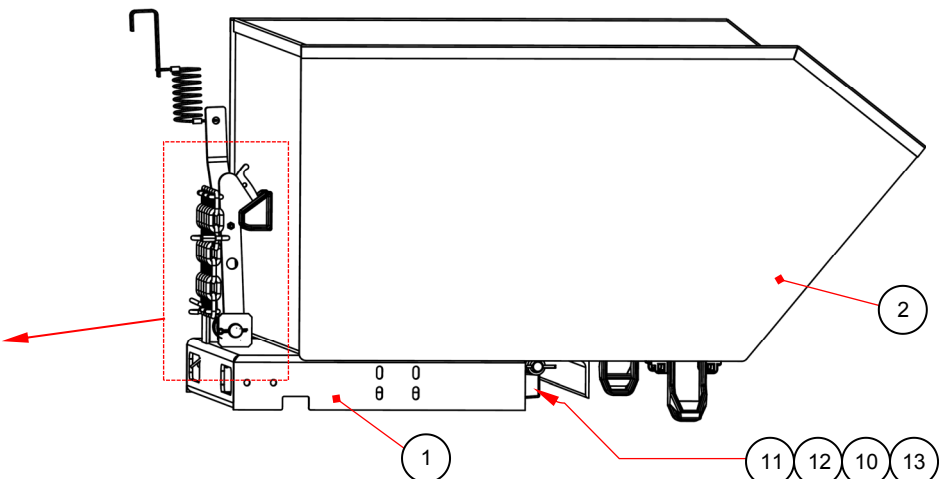
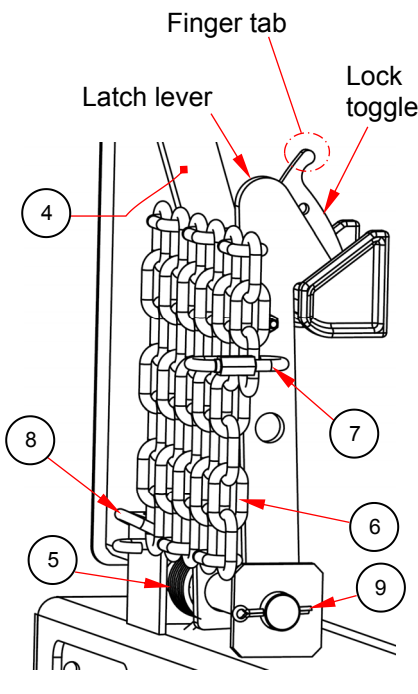

H-150-LD/MD/HD -GAL hoppers exploded view and bill of materials

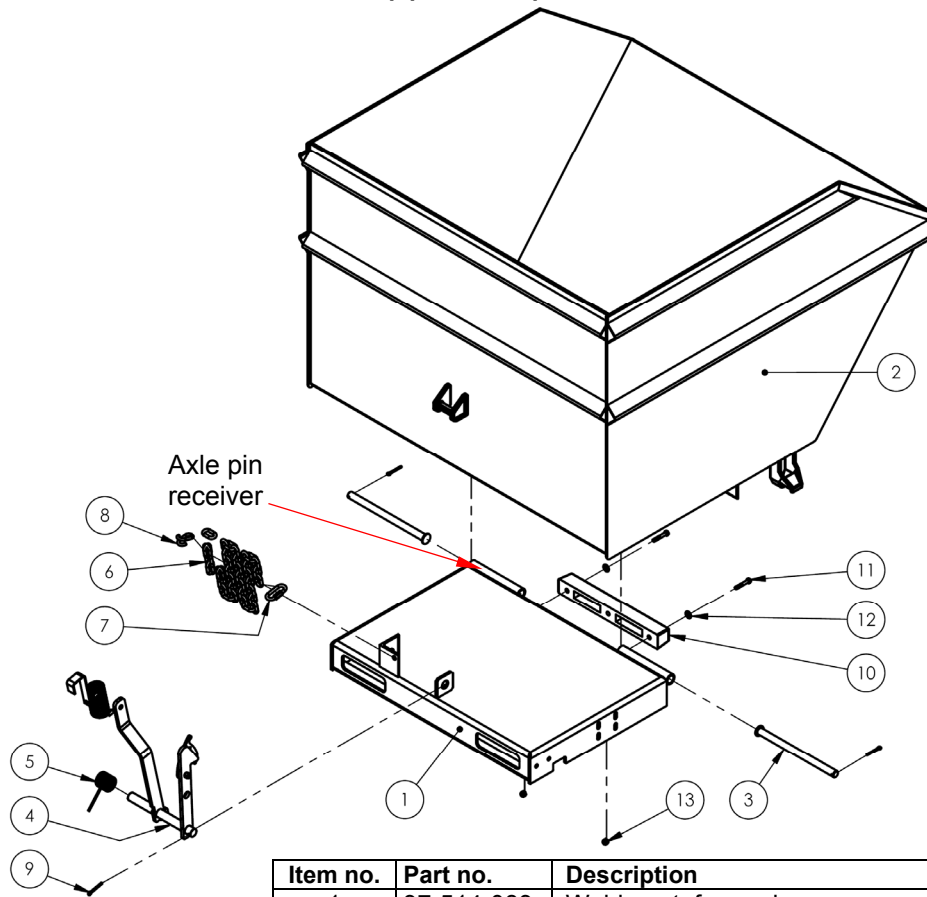

Item no.	Part no.	Description	Quantity
1	37-514-083	Weldment, frame, base	1
2	37-545-131	Weldment, chute, galvanized	1
	37-545-135	H-150-LD-GAL & H-150-MD-GAL	1
		H-150-HD-GAL	1
3	37-112-045	Pin, connecting rod	2
4	37-537-021	Weldment, lock, release lever assembly	1
5	37-146-005	Spring, torsion, hopper, release	1
6	09-145-018	Chain, $\frac{5}{16}$ " x 56" long	1
7	99-145-053	$\frac{5}{16}$ " quick link	1
8	99-145-084	Lap link	1
9	65127	Cotter pin, z-plated, $\frac{3}{16}$ " x 2"	3
10	29-048-061	Bumper, rubber	1
11	11061	Bolt, HHCS #2 z-plated, $\frac{5}{16}$ "-18 x 2"	2
12	33006	Flat washer, z-plated, USS, $\frac{5}{16}$ "	2
13	37021	Lock nut, gr 2, zinc finish, $\frac{5}{16}$ "-18	2

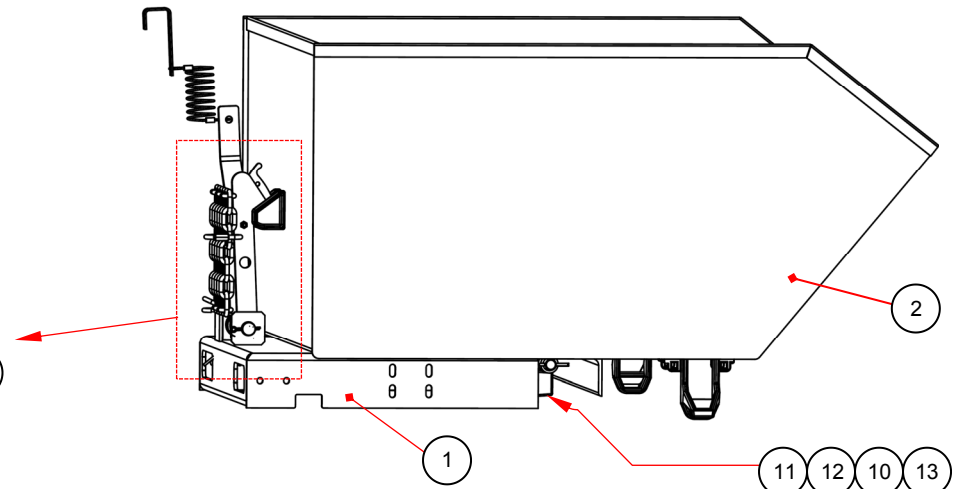
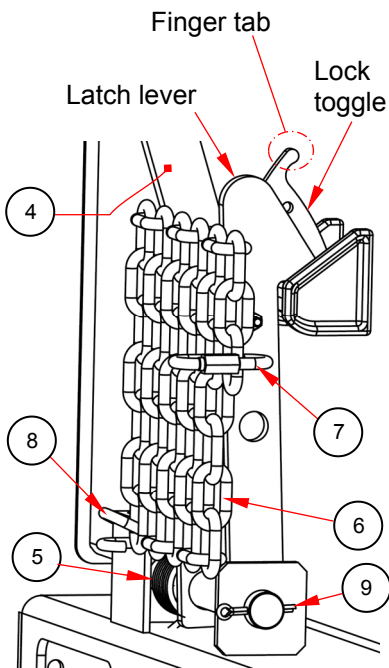

Loading Instructions:

Verify that the hopper chute is securely latched and locked to the base frame before filling it with refuse. Standard H-series self-dumping hoppers are suitable for use indoors and outdoors and in most industrial and commercial settings. They are designed for use with a rider forklift truck to provide a means for dumping non-hazardous refuse.

Use Instructions:

These hoppers have a low profile and rotate through a 90° dump angle. To dump the hopper chute, a forklift operator must simply unlock the release lever and pull the release cable.

Step 1: Mount the hopper on the forks of your lift truck. Drive forward until the forks contact the ends of the fork slots. Securely attach the hopper to the fork carriage with the safety chain by wrapping the free end of the chain around part of the carriage. Then, connect the quick link at the end of the chain to a link in the chain. There should be little to no slack in the chain.

Step 2: Store the handle of the release cable within reach of the forklift operator. For example, the handle could be hooked to the frame of the roll cage.

NOTE: Make sure that there is slack in the cable. If the cable is taut, bumps or sudden stops while driving might cause the chute to be released.

Step 3: Drive the forklift to the trash dumpster. Unlock the latch lever by pulling the finger tab until the lock disengages the latch bar (see diagrams included with Step 4 below). Elevate the hopper above the sides of the dumpster as shown in the diagrams below, and tilt the forklift mast forward.

Step 4: Dump the contents of the hopper by releasing the chute. To release the chute, pull the release cable. The chute will pivot about the dump axis. **NEVER WRAP THE RELEASE CABLE AROUND YOUR HAND!**

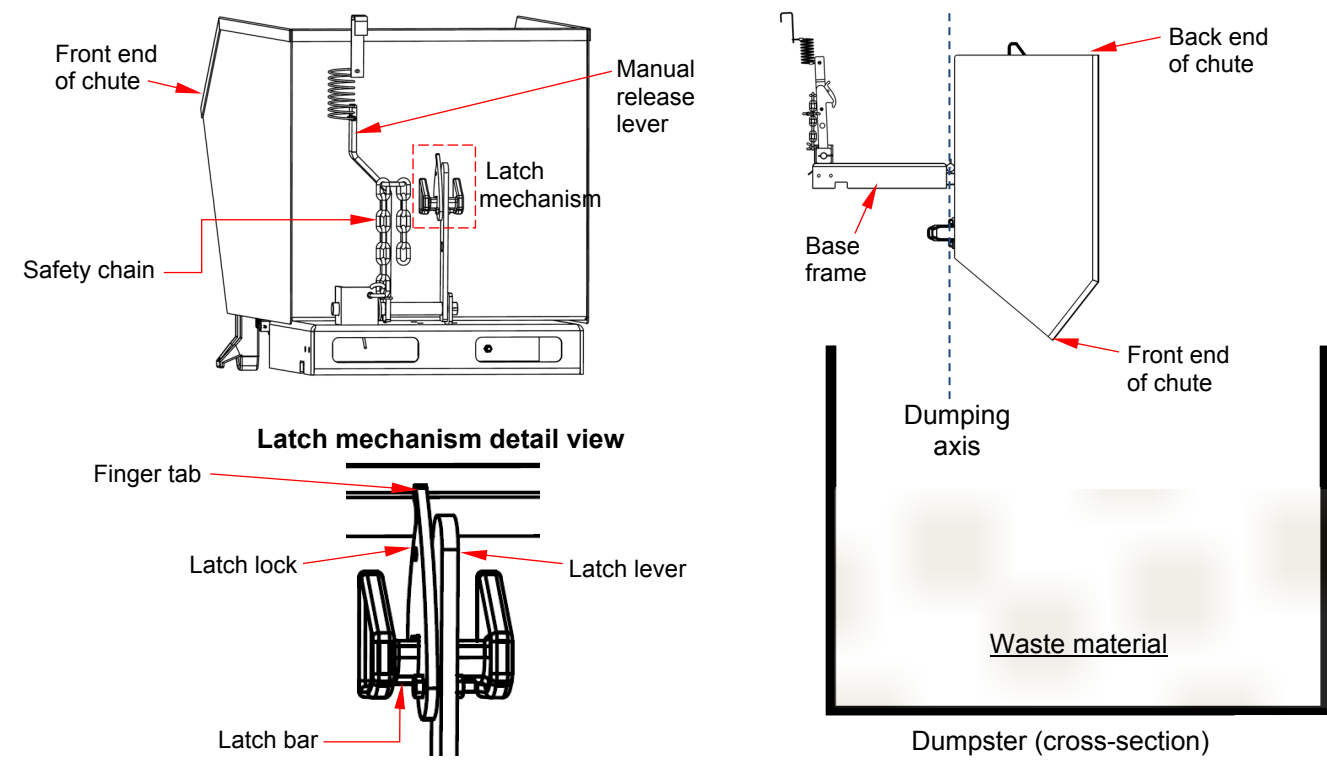

Step 5: Return the chute to the latched position. Tilt the forklift mast toward the cab; then back away from the dumpster. Lower the forks until the hopper contacts the ground; then slowly lower the forks the rest of the way to the ground until the chute latches to the base frame. Confirm that the chute is properly latched by raising the forks. The chute should not rotate. If necessary, lower the forks completely and manually latch the chute to the frame by pressing down on the back of the chute (see "H-series" diagram in Step 4). Alternatively, use the side of the dumpster to pivot the chute back onto the base frame.

Step 6: Lock the latch. Press the latch lock forward until it firmly engages the latch bar.

Stacking Hoppers

H-series hoppers are designed to stack on top of each other. Notches in the base and rim grooves in specially designed cast feet of one hopper engage the rim of the hopper supporting it as shown in the diagram to the right.

Hoppers of identical width can be stacked together, i.e. H-25 and H-50 series hoppers stack together. H-100 and H-150 series hoppers also stack together. Always unload hoppers before stacking them and NEVER create stacks of more than 3 hoppers. The bottom hopper must not be equipped with casters.

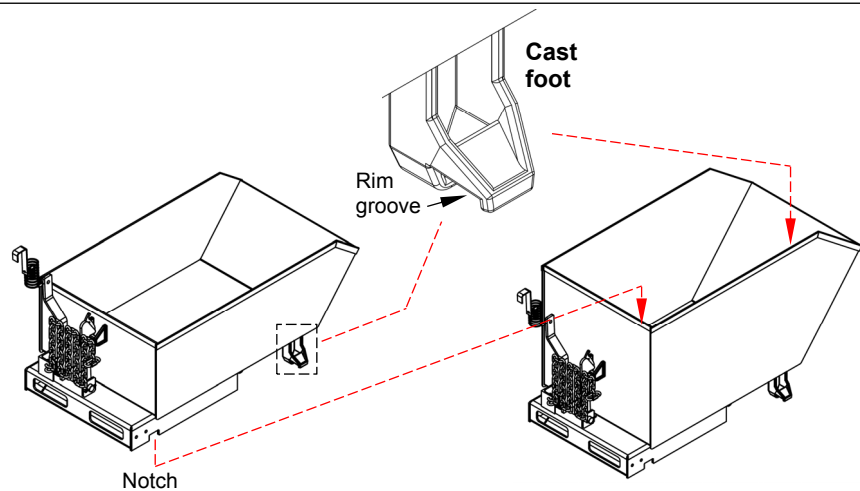

⚠WARNING DO NOT move stacked hoppers! Only move hoppers one at-a-time by properly mounting each hopper to your forklift as described in Step 1 on p. 9. All hoppers must be empty as long as they are stacked.

Inspections & Maintenance

Written record:

Before using this hopper for the first time, create a written record describing its appearance and features. Include descriptions of the chute, feet, base, safety chain and quick link, pivot points and pivot point hardware, and the chute release mechanism. Release the chute. Describe how the unit looks and sounds as the chute rotates. Also describe the force necessary to release the chute using the manual release lever (see p. 9) as well as the cable and handle. Secure the chute to the base and describe how the latch mechanism works. Take photos of the unit and add the photos to the record. This record establishes normal condition. **During future inspections, compare your findings to the record to determine if the unit is in normal condition.** If issues are discovered during an inspection, remove the hopper from service. Restore the hopper to normal condition BEFORE using it again. DO NOT continue to use a structurally damaged hopper. Examples of structural damage include cracked welds, warping or deformation of one or both of the fork pockets, chute, pivot points, or frame members.

Inspections:

Inspect the following components at least once per month and replace any component that is excessively worn or no longer operates normally:

- 1.) Pivot points: check for excessive wear, warping, or other significant damage to pivot pins, cotter pins, and pin receivers.
- 2.) Hopper chute and base frame: examine the structure for damage, deformations, corroded, or excessively rusted regions
- 3.) Hardware (bolts, nuts, pins, cotter pins, retaining rings): inspect hardware for looseness and severe wear. Tighten loose connections and replace all damaged hardware.
- 4.) Casters (if hopper is equipped with caster kit): check for looseness, excessive wear, or damage to the casters, caster bearings, mounting brackets, and hardware.
- 5.) Release mechanism: the torsion spring should cause the latch lever to automatically recoil and the lever should firmly engage the release lock bar. Check the release cable for fraying, thinning, and bird-caging regions.
- 6.) Moving parts: listen for unusual noises and watch for irregular movement. Remove dirt and debris from areas that could affect the hopper's dumping motion.
- 7.) Safety chain: examine the safety chain, its point of attachment to the base frame, and the quick links for damage.
- 8.) Labels: all labels must be firmly affixed in the locations shown in the "Labeling Diagram" on p. 11.

Maintenance:

Implement a maintenance program to ensure that the product functions properly and is adequately maintained. The following steps should be applied to complement established maintenance programs.

Step 1: Tag the hopper, "Out of Service."

Step 2: Inspect the unit as described above. If deformity, corrosion, rusting, or excessive wear of structural members is found, DO NOT continue to use the product.

Step 3: Perform all necessary replacements and/or repairs. Do not modify the hopper!

Step 4: Make a dated record of all repairs made to the hopper.

Labeling diagram

Your hopper should be labeled as shown in the diagram below. However, labeling is subject to change without notice and your hopper might be labeled differently. Be sure to include photographs of every label in your written record (see p. Do not use the hopper unless all labels are intact and easily readable.



A: Label 1023 (both rear corners)



B: Label 220 (both sides below label A)



C: Label 620 (on rear wall facing lift operator)

⚠ WARNING	
	<p>DO NOT wrap release cable around hand.</p> <p>Severe injury or amputation might occur if cable wrapped around body part when chute dumped.</p>
<p>STAY CLEAR of hopper when dumping.</p> <p>DO NOT hook manual release handle on hopper when using bumper release.</p> <p>Each person who uses this hopper should have access to the user manual. Copies of the manual can be downloaded from www.vestil.com.</p>	
⚠ ADVERTENCIA	
<p>NO AGARRAR el cable con la mano.</p> <p>Puede causar un daño severo o amputación si el cable se envuelve alrededor del cuerpo al estar descargando la tolva.</p> <p>MANTENTE ALEJADO de la tolva al descargar.</p> <p>Nunca agarrar el gancho de la tolva.</p> <p>Cada persona que use la tolva debe de usar el manual, las copias se pueden descargar de la dirección www.vestil.com.</p>	

D: (on rear wall facing lift operator) see tables below

Model / Modelo / Modèle	⚠ WARNING	⚠ ADVERTENCIA
H- -	<ul style="list-style-type: none"> SECURELY ATTACH safety restraint to forklift Tilt load backwards to prevent hopper from sliding Distribute load evenly DO NOT exceed rated capacity Hopper MUST be locked when not dumping Disengage lock on hopper release before dumping hopper DO NOT wrap release cable around any body part 	<ul style="list-style-type: none"> ASEGURE la cadena de seguridad a la transeleto Vuelque la carga hacia atrás para prevenir que el carrito resbale Distribuya la carga uniformemente NO exceda la capacidad de carga tasada El depósito de alimentación debe ser cerrado al no descargar Suelte cerradura en la liberación de depósito de alimentación antes de descargar depósito de alimentación No envuelva cable de liberación alrededor de cualquier parte del cuerpo
Capacity / Capacidad / Capacité	lb. kg	
Serial No. / Serie No. / Serie No.		

Model	Label
H-25-LD	627
H-25-MD	549
H-25-HD	538
H-50-LD	629
H-50-MD	535
H-50-HD	628

Model	Label
H-100-LD	533
H-100-MD	536
H-100-HD	539
H-150-LD	534
H-150-MD	537
H-150-HD	590

E: Label 208 (both sides)



F: Label 1058 (warning for California residents; on rear wall facing lift operator)



G: Label 1049 (on rear wall facing lift operator)

⚠ WARNING
<p>Improper use of this fork attachment might result in death or serious injury.</p> <ul style="list-style-type: none"> Before using this fork attachment, US Federal regulation 29 CFR 1910.178 requires you to contact the manufacturer of your lift truck and request: <ol style="list-style-type: none"> Written approval [29 CFR 1910.178(a)(4)] Markings for (fork) lift truck that: <ul style="list-style-type: none"> Identify the attachment; Give approximate weight of truck and attachment at maximum evaluation with laterally-centered load. [29 CFR 1910.178(a)(5)]. DO NOT use UNTIL lift truck is marked with corrected capacity tags. 1049

LIMITED WARRANTY

Vestil Manufacturing Corporation (“Vestil”) warrants this product to be free of defects in material and workmanship during the warranty period. Our warranty obligation is to provide a replacement for a defective, original part covered by the warranty after we receive a proper request from the Warrantee (you) for warranty service.

Who may request service?

Only a warrantee may request service. You are a warrantee if you purchased the product from Vestil or from an authorized distributor AND Vestil has been fully paid.

Definition of “original part”?

An original part is a part used to make the product as shipped to the Warrantee.

What is a “proper request”?

A request for warranty service is proper if Vestil receives: 1) a photocopy of the Customer Invoice that displays the shipping date; AND 2) a written request for warranty service including your name and phone number. Send requests by one of the following methods:

<u>US Mail</u>	<u>Fax</u>	<u>Email</u>
Vestil Manufacturing Corporation	(260) 665-1339	info@vestil.com
2999 North Wayne Street, PO Box 507	<u>Phone</u>	Enter “Warranty service request”
Angola, IN 46703	(260) 665-7586	in subject field.

In the written request, list the parts believed to be defective and include the address where replacements should be delivered. After Vestil receives your request for warranty service, an authorized representative will contact you to determine whether your claim is covered by the warranty. Before providing warranty service, Vestil will require you to send the entire product, or just the defective part (or parts), to its facility in Angola, IN.

What is covered under the warranty?

The warranty covers defects in the following original, dynamic parts: motors, hydraulic pumps, electronic controllers, switches, and cylinders. It also covers defects in original parts that wear under normal usage conditions (“wearing parts”), such as bearings, hoses, wheels, seals, brushes, and batteries.

How long is the warranty period?

The warranty period for original dynamic components is 1 year. For wearing parts, the warranty period is 90 days. Both warranty periods begin on the date Vestil ships the product to the Warrantee. If the product was purchased from an authorized distributor, the periods begin when the distributor ships the product. Vestil may, at its sole discretion, extend a warranty period for products shipped from authorized distributors by up to 30 days to account for shipping time.

If a defective part is covered by the warranty, what will Vestil do to correct the problem?

Vestil will provide an appropriate replacement for any *covered* part. An authorized representative of Vestil will contact you to discuss your claim.

What is not covered by the warranty?

The Warrantee (you) are responsible for paying labor costs and freight costs to return the product to Vestil for warranty service.

Events that automatically void the Limited Warranty.

- Misuse;
- Negligent assembly, installation, operation or repair;
- Installation/use in corrosive environments;
- Inadequate or improper maintenance;
- Damage sustained during shipping;
- Collisions or other accidents that damage the product;
- Unauthorized modifications: Do not modify the product IN ANY WAY without first receiving written authorization from Vestil.

Do any other warranties apply to the product?

Vestil Manufacturing Corp. makes no other express warranties. All implied warranties are disclaimed to the extent allowed by law. Any implied warranty not disclaimed is limited in scope to the terms of this Limited Warranty. Vestil makes no warranty or representation that this product complies with any state or local design, performance, or safety code or standard. Noncompliance with any such code or standard is not a defect in material or workmanship.

