



Vestil Manufacturing Company

2999 North Wayne Street, P.O. Box 507, Angola, IN 46703

Telephone: (260) 665-7586 -or- Toll Free (800) 348-0868

Fax: (260) 665-1339

www.vestil.com

info@vestil.com

HDDL-55 Drum Lifter

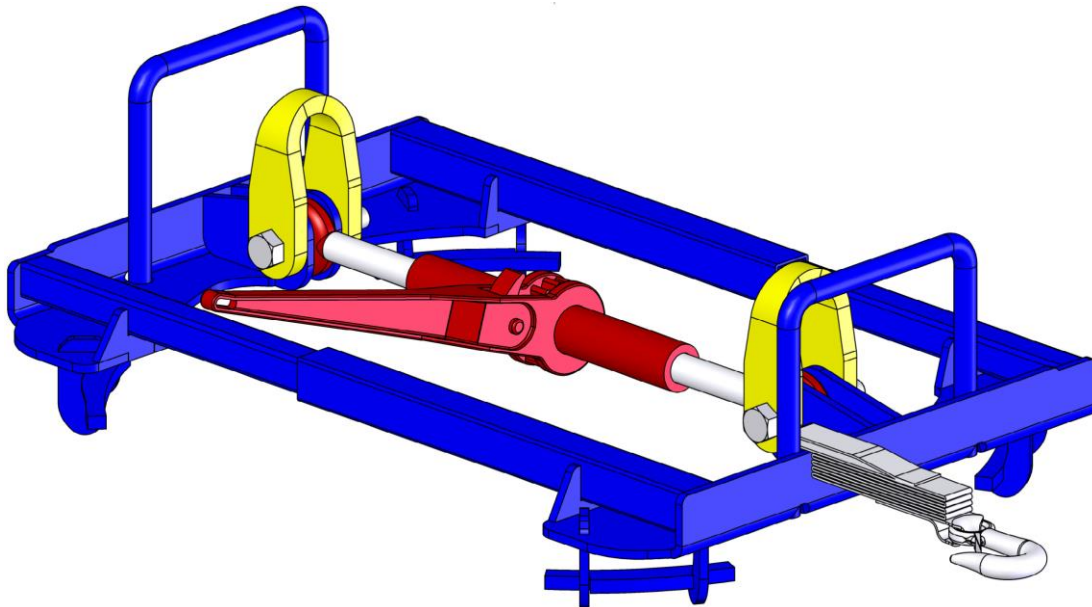

Receiving Instructions

After delivery, remove the packaging from the product. Inspect the product closely to determine whether it sustained damage during transport. If damage is discovered, record a complete description of it on the bill of lading. If the product is undamaged, discard the packaging.

NOTE: The end-user is solely responsible for confirming that product design, use, and maintenance comply with laws, regulations, codes, and mandatory standards applied where the product is used.

Technical Service & Replacement Parts

For answers to questions not addressed in these instructions and to order replacement parts, labels, and accessories, call our Technical Service and Parts Department at (260) 665-7586. The department can also be contacted online at <https://www.vestil.com/page-parts-request.php>.

Electronic copies of Instruction Manuals

Additional copies of this instruction manual may be downloaded from <https://www.vestil.com/page-manuals.php>.



Table of Contents

Page

Signal Words.....	2
Safety Instructions.....	2 - 3
Labeling Diagram.....	3
Exploded View and Bill of Materials.....	4
Specifications.....	4
National Standards.....	5
Using the Lifter.....	5 - 6
Record of Satisfactory Condition.....	6
Load Tests.....	6
Inspections & Maintenance.....	6
Limited Warranty.....	7

SIGNAL WORDS

This manual uses SIGNAL WORDS to indicate the likelihood of personal injuries, as well as the probable seriousness of those injuries, if the product is misused in the ways described. Other signal words call attention to uses of the product likely cause property damage.

 DANGER	Identifies a hazardous situation which, if not avoided, WILL result in DEATH or SERIOUS INJURY . Use of this signal word is limited to the most extreme situations.
 WARNING	Identifies a hazardous situation which, if not avoided, COULD result in DEATH or SERIOUS INJURY .
 CAUTION	Indicates a hazardous situation which, if not avoided, COULD result in MINOR or MODERATE injury.
NOTICE	Identifies practices likely to result in product/property damage, such as operation that might damage the product.

SAFETY INSTRUCTIONS

Vestil strives to identify foreseeable hazards associated with the use of its products. Material handling is dangerous and no manual can address every conceivable risk. Exercise sound judgment at all times.

This HDDL model drum lifter can be used as either a front end attachment for a high lift truck, or as a below-the-hook lifting device for a crane or hoist. ANSI/ITSDF B56.1 is a US national standard that applies to high and low lift trucks and front end attachments. You should acquire a copy of the latest version of ANSI B56.1 from www.ITSDF.org. Apply all portions of Part II "For the User" that are relevant to front end attachments. The following recommendations complement the guidance provided in B56.1.

Similarly, ASME B30.20 is a US national standard that applies to below-the-hook (BTH) lifting devices. If your HDDL lifter will be used as a BTH lifting device, then you should acquire a copy of the current revision of ASME B30.20 and apply all relevant instructions for users of mechanical BTH lifting devices.

The following safety instructions are intended to complement use instructions and safety procedures provided in ANSI B56.1 and ASME B30.20.

WARNING

Risks of serious personal injuries or death.

- DO NOT use, inspect, or service this product until you read and understand the entire instruction manual. Read the manual whenever necessary to refresh your understanding of its contents. Also apply all relevant provisions of the most recent revision of [ANSI/ITSDF B56.1 "Safety Standard for Low Lift and High Lift Trucks"](#) and all laws, regulations, codes, etc. that apply to lift truck attachments where the device is used. If any instruction in this manual conflicts with the Standard, then you should apply the provision in the Standard.
 - DO NOT use this device with rough terrain lift trucks or telehandlers (boom trucks). ONLY use it with high lift fork trucks having a vertical mast and carriage.
 - DO NOT mount the lifter on stackers or manually propelled lift trucks.
 - DO NOT use this device while operating on unimproved surfaces. Only operate on concrete or asphalt.
 - DO NOT disconnect a drum from the drum carrier until the load is entirely and stably supported by the ground or other surface.
 - Inspect the device as instructed in [INSPECTIONS AND MAINTENANCE](#) on p. 6. Acquire a copy of the most recent revision of [ANSI/ITSDF B56.1](#). Apply inspection procedures relevant to lift truck attachments.
 - Maintain the device according to the [INSPECTIONS & MAINTENANCE](#) instructions. **These procedures supplement the maintenance recommendations of ANSI/ITSDF B56.1 (the "Standard")**. DO NOT use the device unless it is in satisfactory condition. See [RECORD OF SATISFACTORY CONDITION](#) on p. 6.
 - Mark your forklift truck to identify the drum lifter attachment and show the approximate weight of the truck and attachment combination at maximum elevation with load laterally centered. Capacity, operation, and maintenance instruction plates, tags, or decals must be changed accordingly.
- When used with a hoist, only attach the lifter to a hoist hook with a spring latch in good condition.
- Inspect the drum lifter as instructed in the [INSPECTIONS & MAINTENANCE](#)
 - DO NOT use the device unless it is in satisfactory condition. If you observe damage, for example significant damage to either or both fork pockets, the safety chain/strap, or the drum-gripping mechanism, tag the unit "Out of Service". Report the issue(s) to maintenance personnel. DO NOT use the lifter until it is restored to satisfactory condition.
 - Inspect the drum before engaging it with the lifter. Make sure that the drum (particularly the rim and rolling hoops) is in good condition. DO NOT attempt to lift or transport a damaged drum with the lifter.

⚠ WARNING (continued from prior page)

- Stay clear of the drum and lifter while the lifter is in use! No part of your body should ever be beneath any part of the elevated lifter or drum. NEVER lift a drum over people.
- ONLY use this device to move closed head and open head steel drums. If used to move open head drums, lids must be installed and solidly fastened to them. ONLY attach the lifter to the top rim of a drum. DO NOT use this lifter to move a drum if the jaws cannot securely clamp the rim.
- DO NOT raise a drum higher than necessary. Only elevate a drum a few inches above the ground.
- Transport drums slowly. Avoid bumps, potholes, etc. when transporting a drum which could disrupt the lifter's grasp on the rim.
- Avoid sudden stops when transporting drums. Brake gradually. Sudden stops could cause the lifter to slide on the forks and could damage the safety strap, hook, and/or quick link. Turn slowly. Sharp, quick turns could disrupt the clamp on the drum and damage the lifter.
- DO NOT modify the lifter in any way. **Unapproved modifications automatically void the LIMITED WARRANTY (see p. 7) and might make the product unsafe to use.**
- DO NOT use the lifter unless labels are in place, readable, & undamaged. See LABELING DIAGRAM, p. 6.
- DO NOT use the drum lifter without the safety chain. The safety chain is an essential safety-enhancing feature. Always wrap the chain around the fork carriage and fasten the free end to the chain or quick link **without slack** whenever the lifter is used.
- DO NOT lift a drum lying on its side. All drums must be upright before attaching the lifter to them.
- DO NOT stand, sit, or ride on a suspended drum.
- DO NOT attempt to lift a drum that weighs more than the capacity of the lifter (1,500 lb.; 681.8 kg).
- DO NOT leave a suspended drum unattended.
- DO NOT release a drum while it is suspended. Lower the drum completely before releasing it.

LABELING DIAGRAM

The unit should be labeled as shown in the diagram. Compare this diagram to your RECORD OF SATISFACTORY CONDITION (see p. 6). Replace all labels that are damaged, missing, or not easily readable (e.g. faded). Order replacement labels by contacting the TECHNICAL SERVICE & REPLACEMENT PARTS DEPARTMENT online at <https://www.vestil.com/page-parts-request.php>. Alternatively, you may request replacement parts and/or service by calling (260) 665-7586 and asking the operator to connect you to the Parts Department. Label content and location are subject to change.

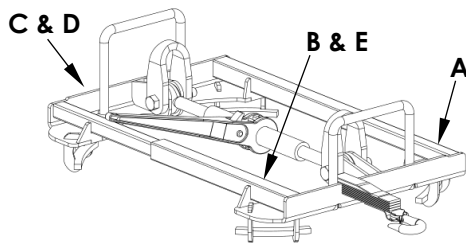

C: Label 675

⚠ WARNING	⚠ ADVERTENCIA
<ul style="list-style-type: none"> • DO NOT exceed rated capacity • DO NOT use if damaged, malfunctioning, or missing parts • DO NOT lift people OR lift loads over people • DO NOT raise load higher than necessary • DO NOT leave a suspended load unattended • DO NOT use lifter unless you read and understand the owner's manual • DO NOT alter OR modify lifter • DO NOT remove OR obscure any label • STAY CLEAR of suspended loads • Secure load before using this device 	<ul style="list-style-type: none"> • NO exceda la capacidad tasada • NO USE si las partes estan dañadas, no funcionan correctamente o faltan partes. • NO eleve al personal o eleve cargas sobre el personal • NO eleve la carga mas alto de lo necesario • NO deje desatendida una carga que este suspendida • NO use el elevador a no ser que haya leído y entendido las instrucciones del manual del propietario • NO altere o modifique el elevador • NO quite u oscurezca ninguna etiqueta • MANTENGASE alejado de las cargas suspendidas • Asegure la carga antes de usar este dispositivo. rev 1212

E: Label 1049

⚠ WARNING
<ul style="list-style-type: none"> • Improper use of this fork attachment might result in death or serious injury. • Using this front end attachment affects lift truck center of gravity. • Before using this fork attachment, US Federal regulation 29 CFR 1910.178 requires you to contact the manufacturer of your lift truck and request: <ol style="list-style-type: none"> 1. Written approval [29 CFR 1910.178(a)(4)] 2. Markings for (fork) lift truck that: <ul style="list-style-type: none"> - Identify the attachment; - Give approximate weight of truck and attachment at maximum elevation with laterally-centered load. [29 CFR 1910.178(a)(5)]. • DO NOT use UNTIL lift truck is marked with corrected capacity tags. • CAPACITY OF TRUCK & ATTACHMENT COMBINATION MIGHT BE LESS THAN CAPACITY OF ATTACHMENT. CONSULT TRUCK CAPACITY TAG/LABEL. 1049 rev 1120

A: Label 218

⚠ WARNING	⚠ ADVERTENCIAS
<ul style="list-style-type: none"> • Improper use might result in death or serious personal injury. Attach device to fork carriage with safety chain/strap. • Drive lift truck forward until forks contact ends of fork pockets. • Chain/straps must not be able to disconnect (slide free) from carriage. • Safety chain/strap must be taut. Connect chain/strap to carriage via shortest line. 	<ul style="list-style-type: none"> • El uso impropio puede resultar en muerte o heridas personales. Atar aparato al mástil del montacargas con cadenas/correas. • Maneje el montacargas para adelante hasta que las cuñas hagan contacto con la orilla del bolsillo de las cuñas. • La cadenas y correas no deben de desizarse (soltarse) del mástil del montacargas. • La cadena/correa de seguridad debe de estar apretado. Asegure la cadena/correa al mástil via la ruta mas corta. 218 rev 0910

B: Label 1000

Model No. _____	Serial No. _____
No. Modelo _____	No. Serie _____
Capacity _____ lbs.	Lifter Weight _____ lbs.
Capacidad _____ kgs.	Peso del Elevador _____ kgs.
<small>BHT-1 Design Category: B BHT-1 Service Category: 1 BHT-1 Categoría de Diseño: B BHT-1 Categoría de Servicio: 1</small>	
Read Owners Manual for product safety warnings Lea Manual de Proprietarios para advertencias de seguridad de producto	

D: Label 1210

⚠ WARNING
<ul style="list-style-type: none"> • Unsafe use of this front end attachment creates risks of serious personal injuries and/or death. 1210 • DO NOT use this front and attachment with rough terrain lift trucks or telehandlers (boom lifts). • ONLY use this attachment with high lift fork trucks utilizing a vertical mast and carriage. • DO NOT operate truck with attachment on unimproved surfaces. ONLY operate the truck with the attachment on concrete or asphalt surfaces capable of supporting the truck and a full capacity load.

EXPLODED VIEW AND BILL OF MATERIALS (09-006-143)

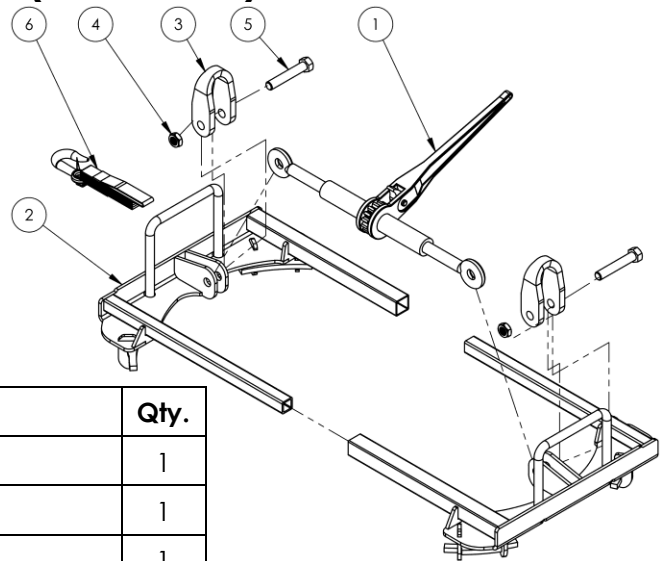

Item	Part no.	Description	Qty.
1	01-127-010	MANIFOLD, L-H-L	1
2	99-034-008	COIL WITH DIN CONNECTOR	1
3	99-144-008	O-RING, MANIFOLD, 1/2" OD	1
4	99-144-009	O-RING, MANIFOLD, 3/4" OD	1
5	99-153-006	VALVE, PRESSURE RELIEF, 210 BAR	1
6	99-153-011	CHECK VALVE, SIZE 08, NOSE-IN/SIDE-OUT	1
7	99-153-015	VALVE SOLENOID, STANDARD	1
8	99-153-038-001	FLOW CONTROL, PRES. COMP., 1.0 GAL.	1

SPECIFICATIONS

A document that provides specifications information, such as dimensions, net weight, and capacity, for your HDDL-55 drum lifter is available on the Vestil website: www.vestil.com. To access the relevant specifications document, navigate to the HDDL webpage: <https://www.vestil.com/product.php?FID=827>. Scroll the page to the "Product Specifications Table". Click the button in the "PDFs" column that looks like a pencil inside a blue box. A PDF file will open. This file is the specifications document. Print a copy of the document and keep it with your copy of this manual. The following is an exemplar specifications document for model HDDL-55.

HEAVY DUTY DRUM LIFTER - HDDL-55

APPROX WEIGHT: 41.25 lbs. (DOES NOT INCLUDE WEIGHT OF POWER OR PACKAGING)
 *** ANY ADDITIONS, DELETIONS, OR OMISSIONS MUST BE CORRECTED ON THIS DRAWING AS THIS DRAWING WILL BE CONSIDERED ALL INCLUSIVE ***
 ALL GRAPHICS PROVIDED ARE FOR REFERENCE ONLY. IF CERTAIN DIMENSIONS ARE CRITICAL PLEASE VERIFY THOSE DIMENSIONS WITH YOUR SALESPERSON

STANDARD FEATURES
 MODEL NUMBER IS HDDL-55
 OVERALL WIDTH IS 18 1/2"
 EXTENDED LENGTH IS 26"
 RETRACTED LENGTH IS 20"
 OVERALL HEIGHT IS 8 5/8"
 MAX CAPACITY IS 1500 LBS.
 DESIGNED FOR LIFTING 55 GAL. CLOSED-HEAD DRUMS IN THE VERTICAL POSITION
 INTEGRAL LOOPS INCLUDED FOR USE WITH FORK TRUCK FORKS/TINES
 USABLE FORK POCKET HEIGHT IS 3 3/8"
 USABLE FORK POCKET WIDTH IS 6 1/8"
 INCLUDES LIFTING POINTS FOR ATTACHING SLINGS OR CHAINS
 INCLUDES SAFETY RESTRAINT
 TOUGH BAKED IN POWDER COATED BLUE FINISH

SPECIAL FEATURES
 NONE

APPROX. WEIGHT/ LOST LOAD= 42 LBS. (APPROX)
 MINIMUM EFFECTIVE THICKNESS= < 1"
 NEVER EXCEED LOAD CENTER RATINGS PER FORK TRUCK MANUFACTURER'S GUIDELINES.
 DO NOT USE THIS FORK TRUCK ATTACHMENT IF LOAD WILL EXCEED FORK TRUCK MANUFACTURER'S LOAD CENTER RATING.

DIMENSION TOLERANCE ± 1/4"

I, THE UNDERSIGNED, AGREE THAT THE PRODUCT AS REPRESENTED SATISFIES DESIGN AND DIMENSION REQUIREMENTS. I ALSO ACKNOWLEDGE MY DUTY TO CONFIRM PRODUCT AND INSTALLATION COMPLIANCE WITH ALL APPLICABLE FEDERAL, STATE AND LOCAL REGULATIONS AND STANDARDS. **UNITS REQUIRING APPROVAL DRAWINGS OR MODIFIED ARE NON-RETURNABLE**
 As drawn As marked

APPROVAL: Signed: _____ Date: _____
 Printed Name: _____
 LEAD TIME WILL START UPON RECEIPT OF SIGNED APPROVAL DRAWING

DISTRIBUTOR'S NAME: VESTIL MANUFACTURING P.O. # _____
 DRAWN BY: TJM DATE: 06/10/11 SALES: X
 REFERENCE: X SCALE: 1:10 FILE NAME: _____
 QUOTED LEAD TIME: X QUOTE # _____ 09-007-143

NATIONAL STANDARDS

This product can be used as either a front end attachment when mounted on the forks of a fork truck, or a below-the-hook lifter when attached to a hoist or other overhead lifting device.

FRONT END ATTACHMENT

According to US Federal Occupational Safety and Health Administration (OSHA) Rule 1910.178 (29 CFR 1910.178; the "Rule"), this device is a front end attachment for a lift truck whenever it is mounted on the forks of a lift truck. The Rule incorporates American National Standard ANSI/ITSDF B56.1 (the "Standard") published by the Industrial Truck Standards Development Foundation (ITSDF) on its website (www.itsdf.org). The standard is freely downloadable at <http://www.itsdf.org/cue/b56-standards.html>. Before putting this drum mover into service, you must acquire a copy of the Standard. Apply all relevant parts of Part II: For the User. If instructions provided in this manual conflict with the Standard, then you should apply the instructions in the Standard. If you find any such disparities, Vestil request that you immediately share them with our **TECHNICAL SERVICE** personnel. Contact information for **TECHNICAL SERVICE** appears on the cover page of this manual.

BELOW-THE-HOOK LIFTING DEVICE

When attached to an crane, hoist, or other overhead lifting device, the HDDL is a "Below-the-Hook Lifting Device" (BTH lifter). **ASME standard B30.20** (the "Standard") applies to BTH lifters. Acquire a copy of the latest version of the Standard before putting the lifter into service. Follow all use and maintenance/care instructions provided in the Standard as well as all other relevant provisions for owners and users. If content in this manual conflicts with any recommendation or mandatory provision in the Standard, apply the provision from the Standard. Vestil encourages you to immediately contact **TECHNICAL SERVICE** if you discover any conflicts.

USING THE LIFTER

This product can be used either as a below-the-hook lifting device attached to a hoist, or as a forklift attachment.

Step 1: Make sure that the lifter is wide enough to fit over the top of your drum. Moving the handle back-and-forth either extends (widens) or retracts (shortens) the lifter. The orientation of the ratchet pawl determines whether moving the handle causes extension or retraction. Push the upper part of the pawl down to change direction.

Step 2: Set the lifter on top of your drum. The **drum brackets** should slide around the side of the drum so that the telescoping arms rest on top of the drum.

Step 3: Set the pawl appropriately to retract the lifter (draw the ends closer together). Move the handle back-and-forth to bring the two sides of the lifter towards each other. Move the handle until the lifter is securely clamped to the top of the drum. Inspect the clamp and make sure that all **4 rim supports** are below the drum rim and are firmly pressed against the side of the drum.

Step 4: Connect the lifter to a hoist OR mount it on a fork of your lift truck.

- a. Hoist: attach a chain sling to both **shackles** & the hoist hook.
- b. Forklift: drive a fork through both fork loops. Attach the **safety strap** to the carriage of your forklift **without slack**.

Step 5: Test the clamp by raising the drum just a few inches above the ground. Watch the drum and lifter for approximately 10 seconds to be certain that the lifter has an adequate clamp on the rim. If the clamp is adequate, proceed to the next step.

Step 6: Transport the drum to the desired location.

a. **Overhead hoist:** Lift the drum ~ 5-6 inches above the ground. Stand to the side of the drum and stabilize it by grasping the lifter. Minimize drum swing by moving the hoist **slowly**.

b. **Forklift:** drive slowly, particularly while turning. Reduce speed during all turns. Apply the brakes gradually. The lifter should not slide towards the tip of the fork if the safety strap is attached properly.

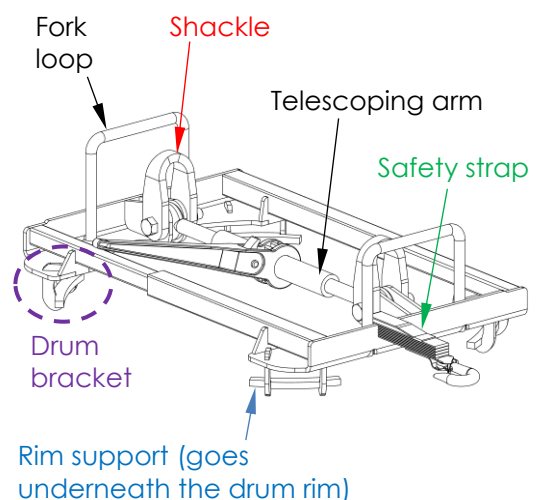
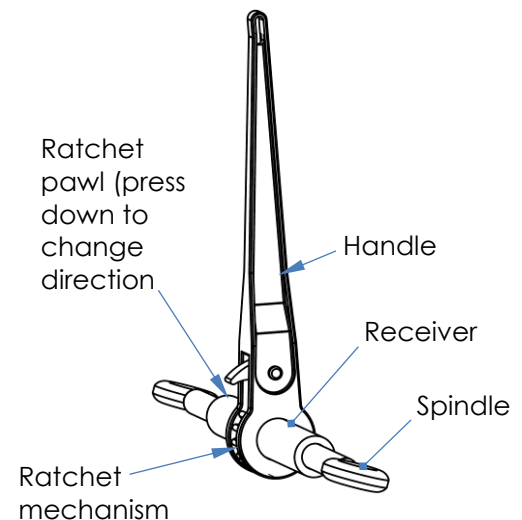

Step 7: Before lowering the drum, make sure that it is not swinging, spinning, etc. Slowly lower the drum until it is stably supported by the ground. Disconnect the lifter from the hoist or demount the lifter from the forklift. Reverse direction of the load binder by pressing down the upper part of the pawl. Move the handle back-and-forth to release the clamp.

RECORD OF SATISFACTORY CONDITION (THE "RECORD")

Record the condition of the lifter before putting it into service. Measure the length and width of each shackle (part no. 28-016-097). Include a width measurement of the mouth of the shackle, i.e. the area that receives the bolt. Record your measurements. Measure the width and height of each fork loop and record your measurements. Extend and retract the lifter by selecting the appropriate pawl configuration and moving the handle back-and-forth. Describe how the spindles wind into their receivers. How much force is required to work the ratchet mechanism? Thoroughly photograph the unit from multiple angles. Include close range photos of all labeling, the lifting shackles and shackle bolts and nuts, the fork loops drum brackets and rim supports, the load binder, and the telescoping arms, safety strap and hook, and all welds. Collect all photographs and writings in a single file. Mark the file appropriately to identify it. The file provides a record of the device in satisfactory condition. Compare the results of all [Inspections](#) (see below) to this *RECORD* to determine whether the unit is in satisfactory condition. If the lifter is not in satisfactory condition, repair it before returning it to service. Purely cosmetic changes, like damaged paint/powdercoat, do not constitute changes from satisfactory condition. However, touchup paint should be applied to all affected areas as soon as cosmetic damage occurs to prevent rusting and corrosion. If left unaddressed, rusting/corrosion will alter the lifter from satisfactory condition and could make it unsafe to use.

LOAD TESTS

After creating a [RECORD OF SATISFACTORY CONDITION](#) and before using the lifter for the first time, a qualified person should conduct a load test. The test load should be 125% of the rated load of the lifter. The rated load (capacity) is 1,500 lb. (681.8kg) of so the test load should be 1,875 pounds (852.3kg). Attach the unit to an appropriately rated overhead lifter. Raise the unit until it is suspended. Leave the unit suspended for a few minutes. Return it to the ground and unload it. Perform a [Monthly Inspection](#) as described in [INSPECTIONS & MAINTENANCE](#) (below). The lifter must undergo load testing immediately after it is repaired, modified, or altered.

INSPECTIONS & MAINTENANCE

Inspection procedures are included in the most current revision of ASME B30.20 and ANSI B56.1. As stated above in the [NATIONAL STANDARDS](#) section, Vestil recommends that you acquire a copy of the most recent revision of each standard. Apply all use and maintenance/care instructions in the standards. Vestil also recommends that you contact your local occupational safety and health authority to determine if any laws, regulations, codes, ordinances, etc. apply inspection requirements to products like this drum lifter.

Inspections and repairs should only be performed by qualified persons. Compare the results of each inspection to the [RECORD OF SATISFACTORY CONDITION](#) (the "RECORD"). Do not use the lifter unless all parts are in satisfactory condition. Replace parts that are not in satisfactory condition before using the lifter again. **DON'T GUESS! If you have any questions about the condition of your lifter, contact the [TECHNICAL SERVICE](#) department.** The phone number is provided on the cover page of this manual. Never make temporary repairs of damaged or missing parts. Only use manufacturer-approved replacement parts. Deformities, cracks, and severe wear of any part of the frame necessitate immediate replacement of the entire unit.

Every lift

Look for dirt or other surface debris. Clean the surfaces.

Monthly Inspections

At least once per month a qualified person must perform the following inspections. Written reports should be prepared for every monthly inspection including inspections following [LOAD TESTS](#).

1. Load binder: Confirm that both spindles wind into, and out of, their receivers smoothly. The pawl should firmly engage the teeth of the ratchet gear in both directions. Spindle and receivers should be straight, undamaged, and free of significant rust/corrosion.
2. Frame (Telescoping arms, drum brackets, rim supports, fork loops, etc.): Check welds and frame members for breaks and severe rusting/corrosion. Remove rust/corrosion with a brush or steel wool. Clean the area and apply touchup paint. Frame members should be square and rigid. Arms should telescope smoothly (without binding). Lubricate arms with a silicone wax whenever necessary.
3. Safety strap and hook: examine the strap for cuts, tears, etc. Verify that the hook latch works properly.
4. Make a dated record of the repairs, adjustments and/or replacements. Only install manufacturer-approved replacement parts. Deformities, cracks, and severe wear of either arm warrants immediate replacement of the entire unit.

LIMITED WARRANTY

Vestil Manufacturing Company ("Vestil") warrants this product to be free of defects in material and workmanship during the warranty period. Our warranty obligation is to provide a replacement for a defective, original part covered by the warranty after we receive a proper request from the Warrantee (you) for warranty service.

Who may request service?

Only a warrantee may request service. You are a warrantee if you purchased the product from Vestil or from an authorized distributor AND Vestil has been fully paid.

Definition of "original part"?

An original part is a part used to make the product as shipped to the Warrantee.

What is a "proper request"?

A request for warranty service is proper if Vestil receives: 1) a photocopy of the [Customer Invoice](#) that displays the shipping date; AND 2) a [written request](#) for warranty service including your name and phone number. Send requests by one of the following methods:

US Mail
 Vestil Manufacturing Company
 2999 North Wayne Street, PO Box 507
 Angola, IN 46703

Fax
 (260) 665-1339
Phone
 (260) 665-7586

Email
info@vestil.com
 Enter "Warranty service request" in subject field.

In the written request, list the parts believed to be defective and include the address where replacements should be delivered. After Vestil receives your request for warranty service, an authorized representative will contact you to determine whether your claim is covered by the warranty. Before providing warranty service, Vestil will require you to send the entire product, or just the defective part (or parts), to its facility in Angola, IN.

What is covered under the warranty?

The warranty covers defects in the following original, dynamic parts: motors, hydraulic pumps, motor controllers, and cylinders. It also covers defects in original parts that wear under normal usage conditions ("wearing parts"), such as bearings, hoses, wheels, seals, brushes, and batteries.

How long is the warranty period?

The warranty period for original dynamic components is 90 days. For wearing parts, the warranty period is 90 days. Both warranty periods begin on the date Vestil ships the product to the Warrantee. If the product was purchased from an authorized distributor, the periods begin when the distributor ships the product. Vestil may, at its sole discretion, extend a warranty period for products shipped from authorized distributors by up to 30 days to account for shipping time.

If a defective part is covered by the warranty, what will Vestil do to correct the problem?

Vestil will provide an appropriate replacement for any covered part. An authorized representative of Vestil will contact you to discuss your claim.

What is not covered by the warranty?

The Warrantee (you) is responsible for paying labor costs and freight costs to return the product to Vestil for warranty service.

Events that automatically void this Limited Warranty.

- Misuse;
- Negligent assembly, installation, operation or repair;
- Installation/use in corrosive environments;
- Inadequate or improper maintenance;
- Damage sustained during shipping;
- Collisions or other accidents that damage the product;
- Unauthorized modifications: Do not modify the product IN ANY WAY without first receiving written authorization from Vestil.

Do any other warranties apply to the product?

Vestil Manufacturing Co. makes no other express warranties. All implied warranties are disclaimed to the extent allowed by law. Any implied warranty not disclaimed is limited in scope to the terms of this Limited Warranty. Vestil makes no warranty or representation that this product complies with any state or local design, performance, or safety code or standard. Noncompliance with any such code or standard is not a defect in material or workmanship.

