

1. Place the small plate on the bottom inside of the Pallet Caddy with the holes towards the opening on the back.
2. Center the plate on bottom and drill (2) 1/4" holes through the Caddy from the inside. Using the holes in plate as guide.
3. Place the big plate on the bottom of Caddy with the teardrop towards the forks.
4. Loosely install the j-hooks through the holes and place on pallet truck.

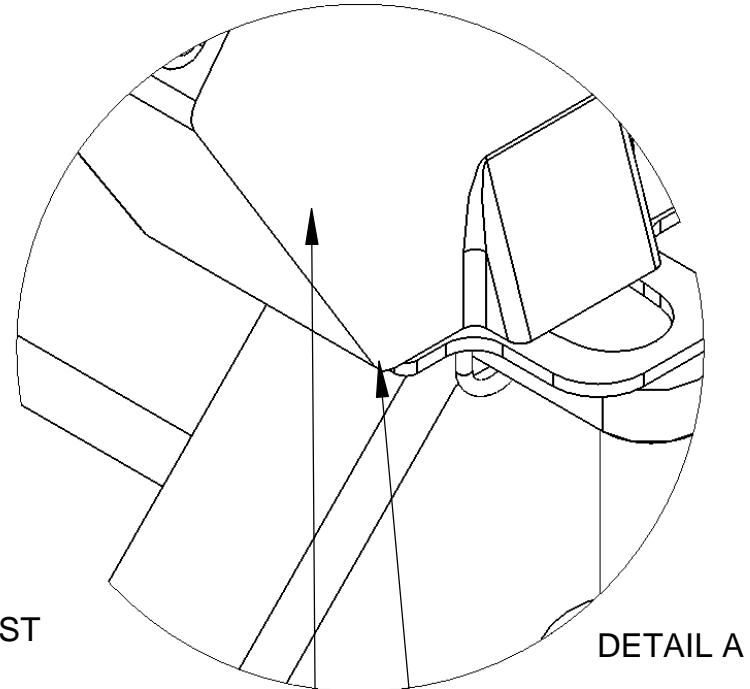
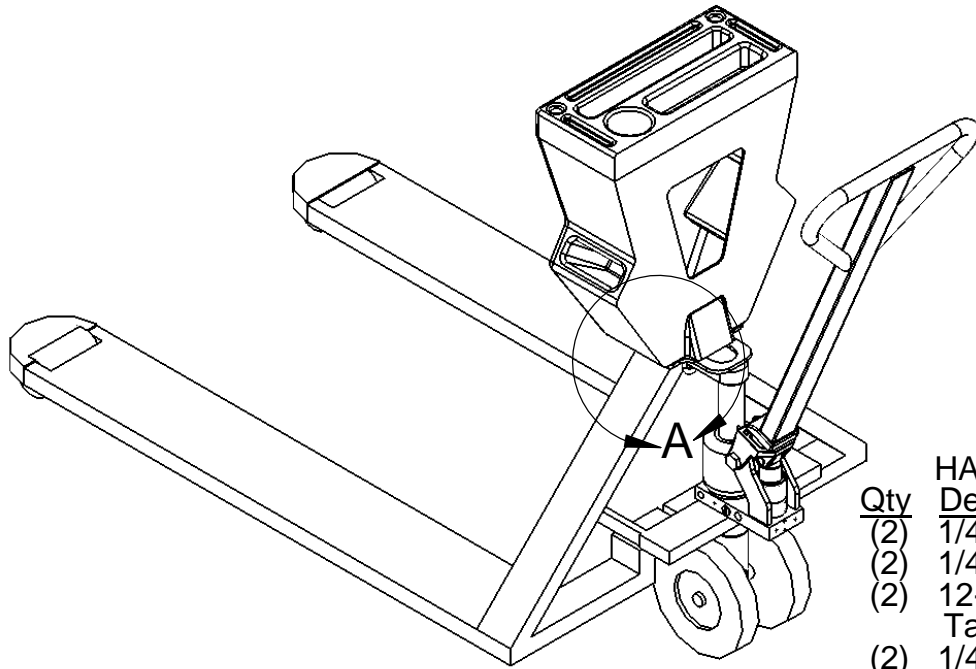

HARDWARE LIST

Qty	Description
(2)	1/4" x 4" J-Bolt
(2)	1/4" Lock nuts
(2)	12-24 x 7/8" Self Tapping Screws (Optional)
(2)	1/4" Flat Washer
(2)	1/4" x 1 1/4" Fender Washer
(1)	Exterior Bracket (15-016-133)
(1)	Interior Bracket (15-016-134)

5. Tighten in small increments from one to another until snug. Make sure unit is level to pallet jack when done.
6. Optional self drilling screws are included. Use if extra stability is needed. Take care not to damage parts on the pallet jack



PROPRIETARY AND CONFIDENTIAL
 THE INFORMATION CONTAINED IN THIS DRAWING IS THE SOLE PROPERTY OF VESTIL MANUFACTURING CO. ANY REPRODUCTION IN PART OR AS A WHOLE WITHOUT THE WRITTEN PERMISSION OF VESTIL MANUFACTURING CO. IS PROHIBITED.

UNLESS OTHERWISE SPECIFIED: REMOVE ALL BURRS AND SHARP EDGES		
DIMENSIONS ARE IN INCHES		
CONCENTRIC	.006 TIR	.060 TIR
ANGLES	± 0° 30'	± 1° 0'
DECIMALS	x.xxx ± .005	
	x.xx ± .010	
FRACTIONS	x.x ± .025	± .015
	± 1/32	± 1/16
TOLERANCES	MACHINE	WELDMENT
COMMENTS:		
DO NOT SCALE DRAWING		

Vestil Manufacturing Co.			
DESCRIPTION: CADDY, CWN INSTALLATION			
PRODUCT MODEL NO: P-CADDY-CWN			
DRAWN BY: TAW	DATE: 7/25/16	SCALE: 1:24	SIZE A
MAT'L: AS LISTED			REV
DWG. NO. P-CADDY-CWN-INS			